

25 COLLEZIONI
26



DECOR
UNION
2000
CERAMICHE

25
YEARS

25 COLLEZIONI

26

B

BELLE EPOQUE	94
BELLE EPOQUE MIX	98
BIANCHI	154
BOISERIE	130
BS JURA	12

C

CALACATTA	60
CAMPIELLO	82
CEMENTO	152
CLASSIC	153
COSTANZA PAV	38
COSTANZA RIV	146
COLORS	117
CRISTAL	148

D

D.A.D.À	102
DECK	74
DIVA	52

E

ETRURIA	85
---------	----

F

FASHION	136
---------	-----

G

GALAXY	18
GEMME	114
GENESI	36

K

KLEN	132
KLEN ESAGONE	108
KLINKER	88

L

LE MASSERIE	24
LE PARETI DI DECOR	122
LINE CEMENT	30
LINWOOD	64
LOFT	116

M

MAGMA	84
MALDIVE	140
MANILA	150
MARMO LUX	144
MARRAKASH	112
MARRAKASH ESAGONE	110
MARTE	34
METALLICA	40
MURETTO 3D	119
MURETTO BRICK	118
MURETTO WALL	120

N

NEW CARIOCA	87
-------------	----

O

OLD BOARDS	78
------------	----

P

PAVIMENTI COORDINATI	86
PIAZZE DI VENEZIA	22
PIETRA LAVAGNA	14
PRESTIGE	6

R

RAWOOD	68
RIVER	83

S

SATÈN PULPIS	46
SEQUOIA	62
SILK	128
SPC	90
STONE	10

V

VALDIVIA	72
VANITY	142
VIVA	138

W

WB	28
WB ESAGONE	106

SIMBOLOGIA

symbols | symbologie

DESTINAZIONE D'USO

intended use



pavimento
floor



rivestimento
wall



mosaico
mosaic

VARIAZIONE CROMATICA

chromatic variation

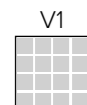

V1
aspetto uniforme
uniform appearance



V2
lieve variazione
slight variation



V3
moderata variazione
moderate variation



V4
forte stonalizzazione
high variation

FINITURE

finishing



Rett **rettificato**
rectified



Nat **naturale**
natural



LP **lappato**
lapped

ALTRE CARATTERISTICHE

more features

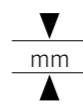

spessore
thickness



ingelivo
no-frost

SUPERFICIE

surface



GRADO DI SCIVOLOSITÀ

slip rate



NOTE TECNICHE

Le informazioni contenute nel presente catalogo sono il più possibile esatte, ma non sono da ritenersi legalmente vincolanti.

Per esigenze di produzione ci riserviamo il diritto di apportare eventuali modifiche che si rendano necessarie. Peso, colori e misure sono soggetti alle inevitabili variazioni tipiche del processo di cottura della ceramica.

I colori si avvicinano quanto più possibile a quelli reali nei limiti consentiti dai processi di stampa.



TECHNICAL NOTES

The information contained in this catalogue is correct to the best of our knowledge, but is not construed as legally binding.

We must reserve the right to make changes every time they will be necessary, according to production needs. The governing sizes are subject to the usual variation expected in fired ceramic products.

Colours shows as close as the limitation of the printing process will allow.



NOTES TECHNIQUES

Les informations contenues dans ce catalogue sont aussi précises que possible, mais ne sont pas contractuelles. Nous nous réservons le droit de procéder à toute modification nécessaire pour des raisons de production.

Poids, couleurs et dimensions sont sujets aux variations typiques du processus de cuisson de la céramique.

Les couleurs imprimées se rapprochent le plus possible des couleurs réelles, dans les limites des procédés d'impression.

INDICE PER TIPOLOGIA

index by type

EFFETTO PIETRA

stone effect | effect pierre

BS JURA	12
GALAXY	18
LE MASSERIE	24
PIAZZE DI VENEZIA	22
PIETRA LAVAGNA	14
PRESTIGE	6
STONE	10

EFFETTO CEMENTO | METALLO

cement metal effect | effect beton metallique

COSTANZA	38
GENESI	36
LINE CEMENT	30
MARTE	34
METALLICA	40
WB	28

EFFETTO MARMO

marble effect | effect marbre

CALACATTA	60
DIVA	52
SATÈN PULPIS	46

EFFETTO LEGNO

wood effect | effect bois

DECK	74
LINWOOD	64
OLD BOARDS	78
RAWOOD	68
SEQUOIA	62
VALDIVIA	72

PAVIMENTI RUSTICI

rustic floor tiles | sols rustique

CAMPIELLO	82
ETRURIA	85
MAGMA	84
RIVER	83

PAVIMENTI BASICI

basic floor tiles | sols de base

NEW CARIOCA	87
PAVIMENTI COORDINATI	86

SUPERFICI ALTERNATIVE

alternative surfaces | surface alternatives

KLINKER	88
SPC	90

STILE DECORATIVO

decorative style | style décoratif

BELLE EPOQUE	94
BELLE EPOQUE MIX	98
COLORS	117
D.A.D.À	102
GEMME	114
KLEN ESAGONE	108
LOFT	116
MARRAKASH	112
MARRAKASH ESAGONE	110
MURETTO 3D	119
MURETTO BRICK	118
MURETTO WALL	120
WB ESAGONE	106

RIVESTIMENTI

wall tiles | faïence

BIANCHI	154
BOISERIE	130
CEMENTO	152
CLASSIC	153
COSTANZA	146
CRISTAL	148
FASHION	136
KLEN	132
LE PARETI DI DECOR	122
MALDIVE	140
MANILA	150
MARMO LUX	144
SILK	128
VANITY	142
VIVA	138

INDICE PER FORMATI

size index

EFFETTO PIETRA	PAG.	120x120	60x120	90x90	80x80	60x60	30x60	30x30
BS JURA	12	●	●			●	●	
GALAXY	18			●		●		
LE MASSERIE	24					●	●	●
PIAZZE DI VENEZIA	22					●	●	
PIETRA LAVAGNA	14	●	●		●	●	●	
PRESTIGE	6		●			●	●	
STONE	10		●			●		

EFFETTO CEMENTO METALLO	PAG.	120x120	100x100	60x120	90x90	80x80	60x60	30x60	32x32
COSTANZA	38						●	●	
GENESI	36			●			●		
LINE CEMENT	30		●	●			●	●	
MARTE	34			●		●	●	●	●
METALLICA	40			●		●	●	●	
WB	28	●		●	●		●	●	

2 CM	PAG.	100x100	60x120	80x80	60x60
BS JURA	12		●		●
LINE CEMENT	30	●			●
PIETRA LAVAGNA	14			●	●

EFFETTO MARMO	PAG.	60x120	90x90	60x60
CALACATTA	60	●		●
DIVA	52	●		●
SATÈN PULPIS	46	●	●	

EFFETTO LEGNO	PAG.	30x120	20x120	61x61	15x60
DECK	74		●		●
LINEWOOD	64	●	●		
OLD BOARDS	78		●		
RAWOOD	68	●	●		
SEQUOIA	62			●	
VALDIVIA	72		●		

PAVIMENTI RUSTICI	PAG.	60x120	60x60	30x60	32x32	20x40	15x30
CAMPIELLO	82				●		●
ETRURIA	85			●		●	
MAGMA	84					●	
RIVER	83	●	●	●			●

PAVIMENTI BASICI	PAG.	45,5x45,5	20,5x20,5
NEW CARIOCA	87		●
PAV. COORDINATI	86	●	

SUPERFICI ALTERNATIVE	PAG.	23x154x5	18,2x122,4	12,7x63,5x5	25x25	12x25
KLINKER	88				●	●
SPC	90	●	●	●		

STILE DECORATIVO	PAG.	25x50	16x40	20x20	10x30	6x25	23x26	17,5x20,2	13,9x16	13x13
BELLE EPOQUE	94			●						
BELLE EPOQUE MIX	98			●						
COLORS	117			●						
D.A.D.À	102			●						
GEMME	114					●				
KLEN ESAGONE	108						●			
LOFT	116				●					
MARRAKASH	112									●
MARRAKASH ESAGONE	110								●	
MURETTO 3D	119		●							
MURETTO BRICK	118	●								
MURETTO WALL	120		●							
WB ESAGONE	106							●		

RIVESTIMENTI	PAG.	60x120	40x120	30x90	25x75	30x60	25x60	26x52	20x60	20x50	20x45	20x20	15x15	10x10
BIANCHI	154			●		●						●	●	●
BOISERIE	130			●										
CEMENTO	152									●				
CLASSIC	153											●		
COSTANZA	146								●					
CRISTAL	148								●					
FASHION	136				●									
KLEN	132				●									
LE PARETI DI DECOR	122	●												
MALDIVE	140						●							
MANILA	150							●						
MARMO LUX	144						●							
SILK	128		●											
VANITY	142						●							
VIVA	138						●							

stone effect | effect pierre

GRES PORCELLANATO RETTIFICATO

rectified porcelain stoneware

UNI EN 14411 BIA GL

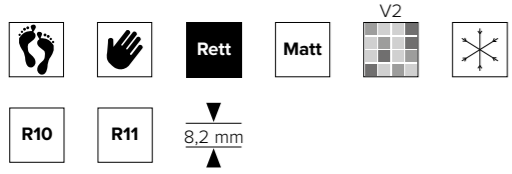

FORMATI

formats

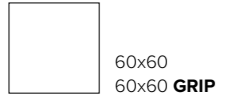

PEZZI SPECIALI

special pieces



battiscopa 7,5x60
Y6 lpz



gradone lineare 60
su richiesta | on request





PRESTIGE BEIGE 60x120 DECO RIGATO PERLA 60x120



PRESTIGE PERLA 60x60

PERLA

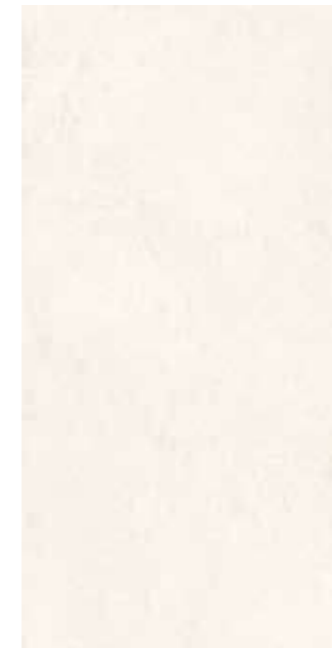

DECO RIGATO PERLA



BEIGE

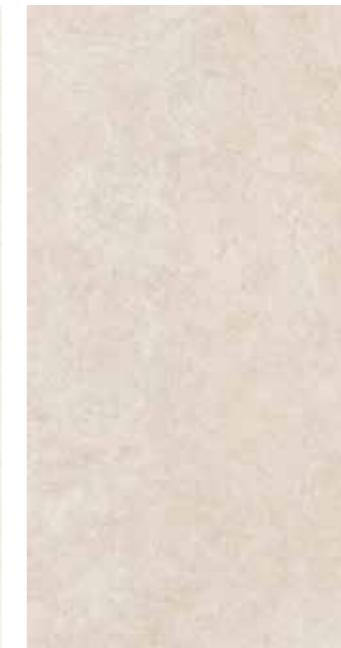

DECO RIGATO BEIGE



GRIGIO



DECO RIGATO GRIGIO



IMBALLI packing	▼ mm ▲	📦 PZ box	📦 MQ box	📦 KG box	📦 BOX pallet	📦 MQ pallet	📦 KG pallet	CODICE PREZZO price code
60x119,8 rett	8,2	2	1,44	23,33	42	60,48	979,86	X43 mq
60x119,8 decor rett	8,2	2	1,44	23,33	42	60,48	979,86	X65 mq
60x60 rett 60x60 GRIP rett R11	8,2	4	1,44	23,33	32	46,08	746	X35 mq
30x60 rett	8,2	8	1,44	23,33	40	57,60	933	X35 mq

stone effect | effect pierre

GRES PORCELLANATO RETTIFICATO

rectified porcelain stoneware

UNI EN 14411 BIA GL

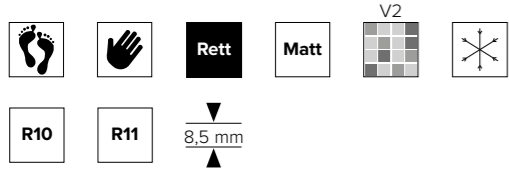

FORMATI

formats

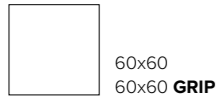
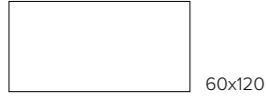

PEZZI SPECIALI

special pieces



battiscopa 7,5x60
Y6 lpz



gradone lineare 60
su richiesta | on request

LIGHT



CREAM



GREY

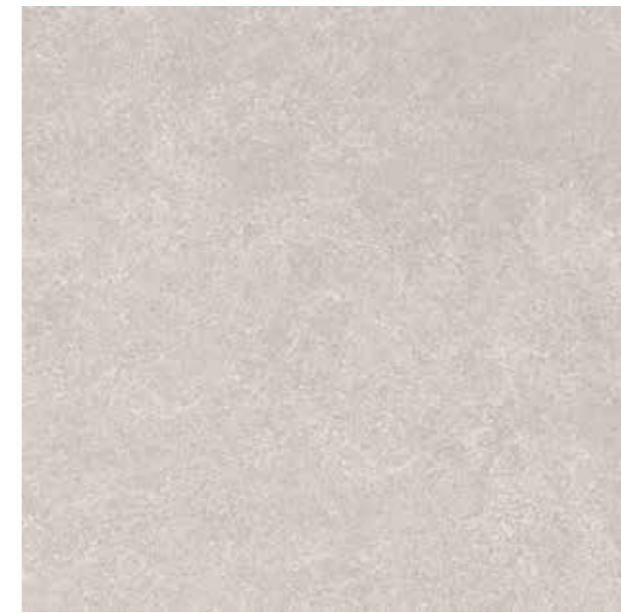

STONE GREY 60x60

IMBALLI packing	mm	PZ box	MQ box	KG box	BOX pallet	MQ pallet	KG pallet	CODICE PREZZO price code
60x120 rett	8,5	2	1,44	29,50	36	51,84	1022,40	C39 lmq
60x60 rett 60x60 GRIP rett R11	8,5	4	1,44	28,50	32	46,08	912	C30 lmq

GRES PORCELLANATO RETTIFICATO

rectified porcelain stoneware

UNI EN 14411 BIA GL



R10 120x120 | 60x120
A+B 60x60 | 30x60

R11 60x120 **2 CM**
60x60 **2 CM**

▼
9,5 mm
▲
120x120

▼
9 mm
▲
60x120 | 60x60 | 30x60

▼
20 mm
▲
60x120 **2 CM**
60x60 **2 CM**



FORMATI

formats

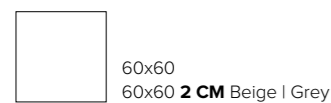
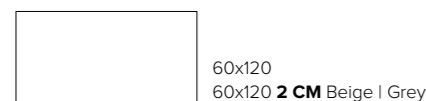
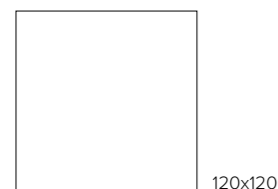

PEZZI SPECIALI

special pieces



battiscopa 7,5x60
Y6 lpz



gradone lineare 60
su richiesta | on request

WHITE



PURE



BEIGE



GREY



Bs Jura 2 CM
60x120 | 60x60 rett R11

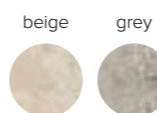

BS JURA PURE 120x120

IMBALLI packing	mm	PZ box	MQ box	KG box	BOX pallet	MQ pallet	KG pallet	CODICE PREZZO price code
120x120 rett	9,5	1	1,44	32,00	40	57,60	1295	S55 lmq
60x120 rett	9	2	1,44	30,55	36	51,84	1074	S42 lmq
60x60 rett	9	4	1,44	28,80	30	43,20	864	S37 lmq
30x60 rett	9	8	1,44	22,52	32	46,08	900	S37 lmq
60x60 2CM rett R11	20	4	1,44	28,80	30	43,20	864	S60 lmq
60x120 2CM ret R11	20	1	0,72	31,00	30	21,60	954	S69 lmq

GRES PORCELLANATO RETTIFICATO

rectified porcelain stoneware

UNI EN 14411 BIA GL



R10 120x120 | 60x120
80x80 | 60x60 | 30x60

R11 80x80 | 60x60 **2 CM**
60x60 **GRIP**

10 mm

20 mm

80x80 **2 CM**
60x60 **2 CM**



FORMATI

formats



PEZZI SPECIALI

special pieces



battiscopa 7,5x60
Y6 lpz



gradone lineare 60
su richiesta | on request





PIETRA LAVAGNA ANTRACITE 60x120

IMBALLI packing	mm							CODICE PREZZO price code
		PZ box	MQ box	KG box	BOX pallet	MQ pallet	KG pallet	
120x120 rett	10	1	1,44	32,00	40	57,60	1295	R55 lmq
60x120 rett	10	2	1,44	30,55	36	51,84	1074	R42 lmq
80x80 rett	10	2	1,28	27,60	48	61,44	1340	R42 lmq
60x60 rett	10	4	1,44	28,80	30	43,20	864	A37 lmq
30x60 rett	10	8	1,44	22,52	32	46,08	900	A37 lmq
60x60 GRIP rett R11	10	4	1,44	28,80	30	43,20	864	A37 lmq
80x80 2CM rett	20	1	0,64	29,00	48	30,72	1410	R72 lmq
60x60 2CM rett	20	2	0,72	31,18	32	23,04	1045	R60 lmq

AVORIO



GRIGIO



SABBIA



ANTRACITE



Pietra Lavagna 2 CM

80x80 | 60x60 rett R11

sabbia grigio antracite



GRES PORCELLANATO RETTIFICATO

rectified porcelain stoneware

UNI EN 14411 BIA GL



R10

▼
9 mm 61x61
▲

▼
9,5 mm 90x90
▲



FORMATI

formats

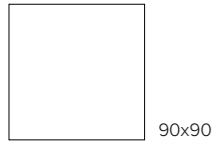

PEZZI SPECIALI

special pieces

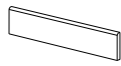

battiscopa 6,5x61
Y6 lpz



gradone lineare 60
su richiesta | on request



COTTO



BIANCO

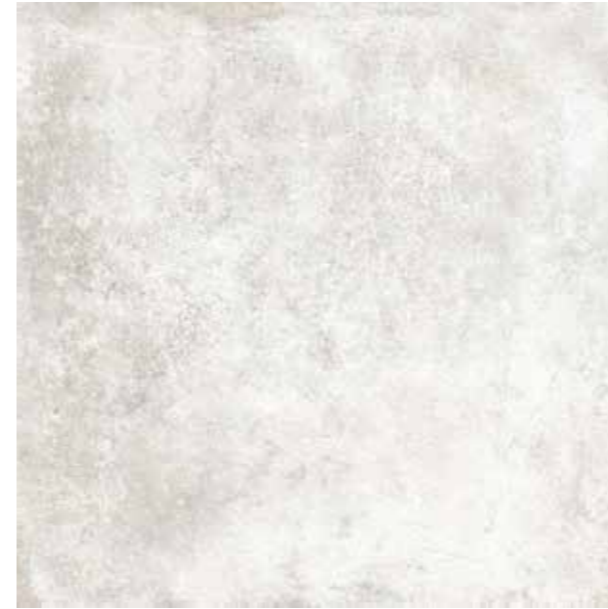

BEIGE









GRIGIO



MIX



GALAXY COTTO 61x61

IMBALLI packing	▼ mm ▲	 PZ box	 MQ box	 KG box	 BOX pallet	 MQ pallet	 KG pallet	CODICE PREZZO price code
90x90 rett	9,5	2	1,62	33,62	21	34,02	724	T42 lmq
61x61 rett	9	4	1,49	30,23	30	44,70	920	T36 lmq

stone effect | effect pierre

GRES PORCELLANATO RETTIFICATO

rectified porcelain stoneware

UNI EN 14411 BIA GL

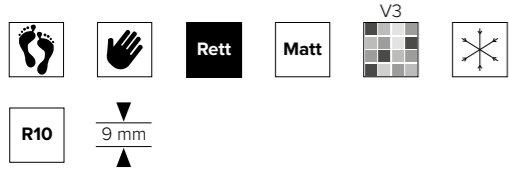

FORMATI

formats

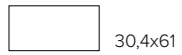

PEZZI SPECIALI

special pieces



battiscopa 7,5x60
Y6 lpz



PIAZZE DI VENEZIA WALNUT 61x61

WALNUT



WASHED



MEDIUM



PIAZZE DI VENEZIA MEDIUM 61x61

IMBALLI packing	mm	PZ box	MQ box	KG box	BOX pallet	MQ pallet	KG pallet	CODICE PREZZO price code
61x61 rett	9	4	1,49	30,45	30	44,70	920	T36 lmq
30,4x61 rett	9	7	1,30	24,50	40	52,00	990	T35 lmq

stone effect | effect pierre

GRES PORCELLANATO RETTIFICATO

rectified porcelain stoneware

UNI EN 14411 BIA GL



R10 61x61 | 30,4x61
30,4x30,4
30x30 **mosaico**

R11 61x61 | 30,4x61 **GRIP**
30,4x30,4 **GRIP**

▼
9,2 mm
▲



FORMATI

formats



61x61
61x61 **GRIP**

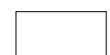

30,4x61
30,4x61 **GRIP**

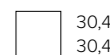

30,4x30,4
30,4x30,4 **GRIP**



30x30 **mosaico**
tessere 5x5

PEZZI SPECIALI

special pieces



battiscopa 7,5x61
Y6 lpz



elemento L monolitico **GRIP**
15x30x3 **Y16 lpz**



ESEMPI DI POSA - multiformato

laying compositions - Multiformat

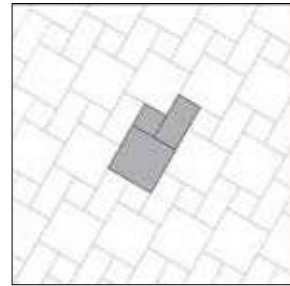

01

61x61 rett. 57,00%
30,4x61 rett. 28,00%
30,4x30,4 rett. 15,00%

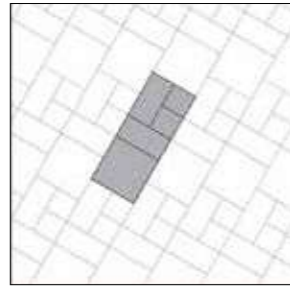

02

61x61 rett. 40,00%
30,4x61 rett. 40,00%
30,4x30,4 rett. 20,00%

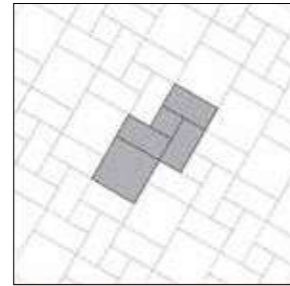

03

61x61 rett. 36,00%
30,4x61 rett. 55,00%
30,4x30,4 rett. 9,00%

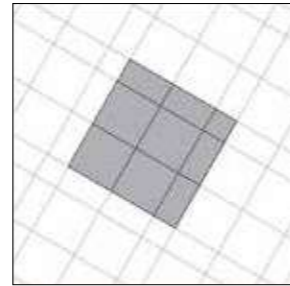

04

61x61 rett. 64,00%
30,4x61 rett. 32,00%
30,4x30,4 rett. 4,00%

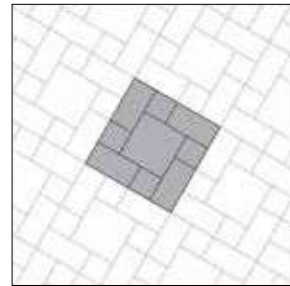

05

61x61 rett. 25,00%
30,4x61 rett. 50,00%
30,4x30,4 rett. 25,00%

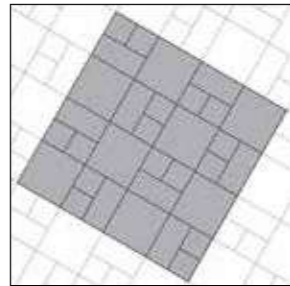

06

61x61 rett. 50,00%
30,4x61 rett. 25,00%
30,4x30,4 rett. 25,00%

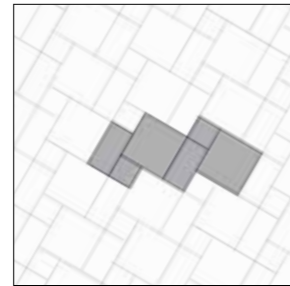

07

61x61 rett. 60,00%
30,4x61 rett. 28,00%
30,4x30,4 rett. 12,00%



LE MASSERIE ALMOND 61x61 | 30,4x61 | 30,4x30,4 (posa 07)

ALMOND



MOSAICO ALMOND

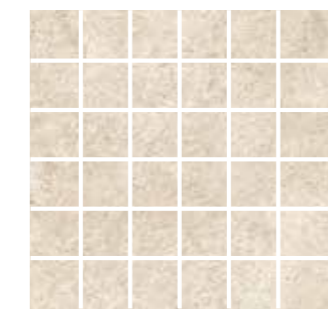

LA CARATTERISTICA E PREGIO DI QUESTO MATERIALE È LA FORTISSIMA STONALIZZAZIONE CHE RENDE UNICO OGNI PAVIMENTO POSATO.

The feature and quality of this material is the very strong colour shading, which makes every single floor unique.



LE MASSERIE ALMOND 61x61 **GRIP** | 30,4x61 **GRIP** | 30,4x30,4 **GRIP** (posa 07)

IMBALLI packing	mm ▲▼	PZ box	MQ box	KG box	BOX pallet	MQ pallet	KG pallet	CODICE PREZZO price code
61x61 61x61 GRIP rett R11	9,2	4	1,49	32,30	30	44,70	980	T40 lmq
30,4x61 rett 30,4x61 GRIP rett R11	9,2	7	1,30	24,50	40	52,00	990	T40 lmq
30,4x30,4 rett 30,4x30,4 GRIP rett R11	9,2	13	1,20	22,62	40	48,00	915	T40 lmq
30x30 mosaico	9,2	11	-	22,00	-	-	-	Y20 lpz

GRES PORCELLANATO RETTIFICATO

rectified porcelain stoneware

UNI EN 14411 BIA GL



R10 **R11** 60x120 | 90x90 **GRIP**
60x60 | 30x60 **GRIP**

▼ 9,5 mm ▲
▼ 8,2 mm ▲ 17,5x20,2 **esagona**



FORMATI

formats

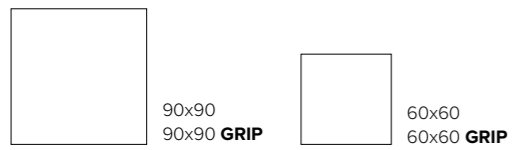
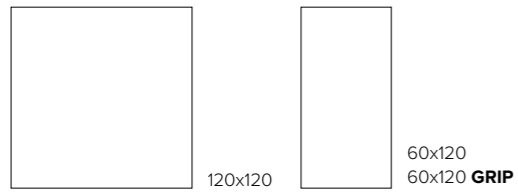

PEZZI SPECIALI

special pieces

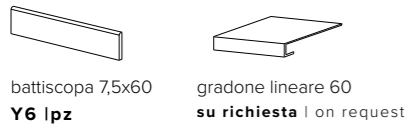

BIANCO



CENERE

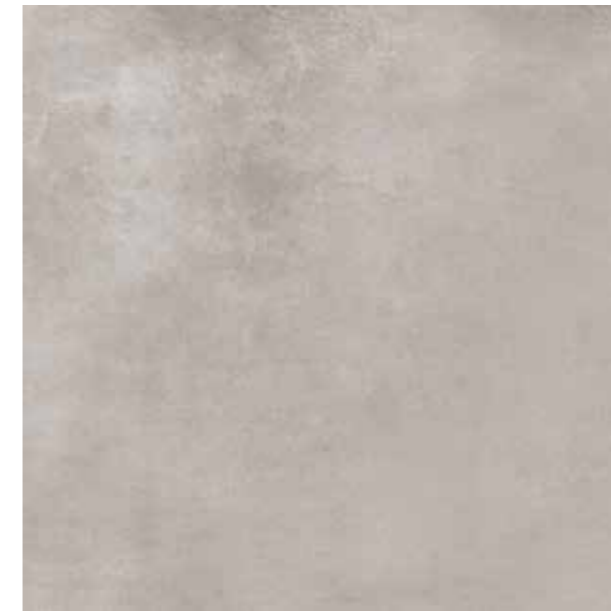

COAL



TAUPE



WB Esagone
pag.106



WB CENERE 60x60

IMBALLI packing	mm ▲▼	PZ box	MQ box	KG box	BOX pallet	MQ pallet	KG pallet	CODICE PREZZO price code
120x120 rett	9,5	1	1,44	35,20	36	51,84	1288	J69 lmq
60x120 rett 60x120 GRIP rett R11	9,5	2	1,44	34,54	36	51,84	1200	J57 lmq
90x90 rett 90x90 GRIP rett R11	9,5	2	1,62	36,00	24	38,88	881	J60 lmq
60x60 rett 60x60 GRIP rett R11	9,5	3	1,08	24,60	40	43,20	947	J50 lmq
30x60 rett 30x60 GRIP rett R11	9,5	6	1,08	24,60	48	51,84	1120	J50 lmq
17,5x20,2 esagona nat R10	8,2	25	0,714	12,76	80	57,12	1021	J87 lmq

GRES PORCELLANATO RETTIFICATO

rectified porcelain stoneware

UNI EN 14411 BIA GL



R10 100x100 | 60x120
60x60 | 30x60

R11 60x60 | 100x100 **2 CM**

$\frac{8,5 \text{ mm}}{\Delta}$ 100x100 $\frac{9,5 \text{ mm}}{\Delta}$ 60x120
60x60 | 30x60

$\frac{20 \text{ mm}}{\Delta}$ 100x100 **2 CM**
60x60 **2 CM** UPEC F+



FORMATI

formats

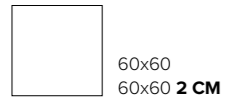
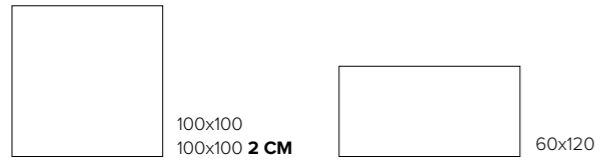

PEZZI SPECIALI

special pieces

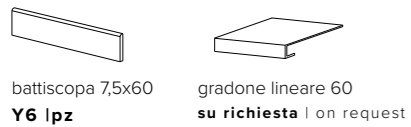



LINE CEMENT CENERE particolare | close up

PERLA

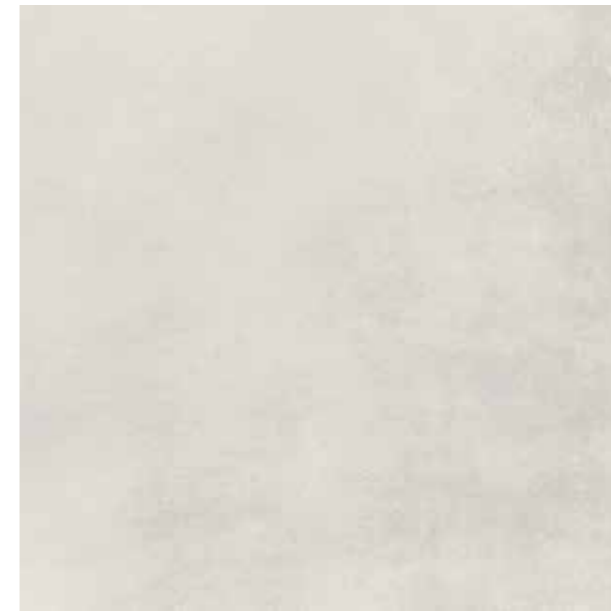

CENERE



SABBIA



GRAFITE

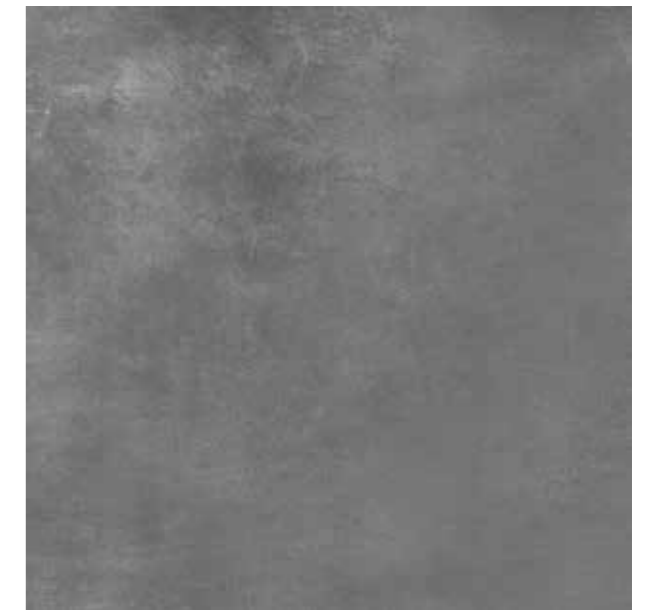

IMBALLI packing	mm	PZ box	MQ box	KG box	BOX pallet	MQ pallet	KG pallet	CODICE PREZZO price code
100x100 rett	8,5	2	2,00	38,00	24	48,00	912	R49 lmq
60x120 rett	9,5	2	1,44	30,00	36	51,84	1080	R41 lmq
60x60 rett	9,5	3	1,08	22,50	40	43,20	900	R37 lmq
30x60 rett	9,5	6	1,08	22,50	40	43,20	900	R37 lmq
100x100 2CM rett	20	1	1,00	42,50	21	21,00	892,50	R90 lmq
60x60 2CM rett	20	2	0,72	31,18	32	23,04	1045	R60 lmq

Line Cement 2 CM
60x60 | 100x100 rett R11



cement metal effect | effect beton metallique

GRES PORCELLANATO RETTIFICATO

rectified porcelain stoneware

UNI EN 14411 BIA GL

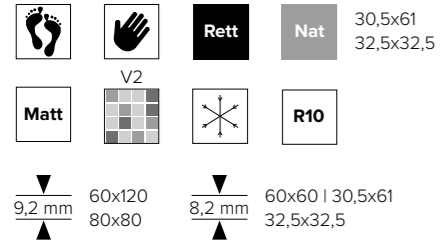

FORMATI

formats

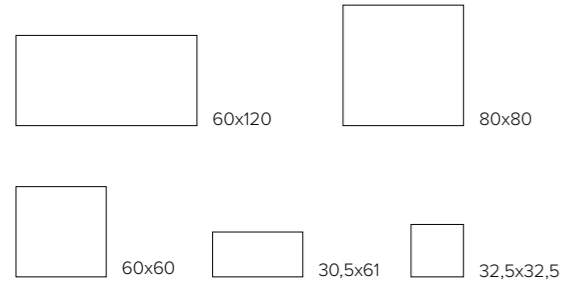

PEZZI SPECIALI

special pieces



battiscopa 7,5x60
Y6 lpz

BEIGE



BIANCO

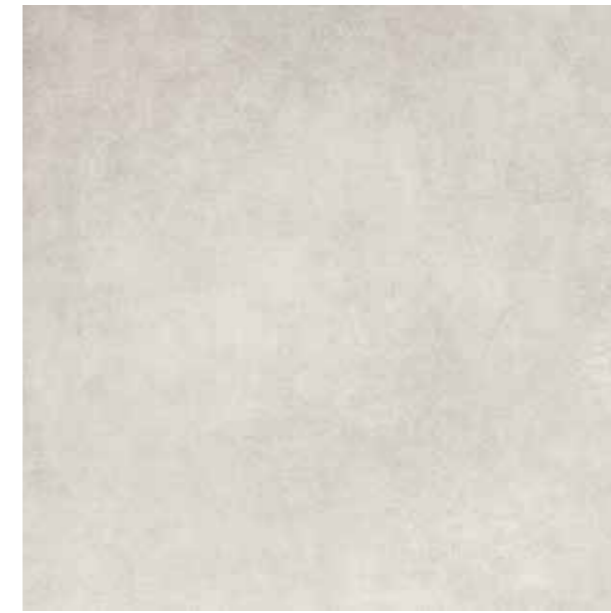

GRIGIO



TAUPE



IMBALLI packing	mm	PZ box	MQ box	KG box	BOX pallet	MQ pallet	KG pallet	CODICE PREZZO price code
60x120 rett	9,2	2	1,44	27,50	36	51,84	1010	I42 lmq
80x80 rett	9,2	2	1,28	24,80	44	56,32	1111,2	I38 lmq
60x60 rett	8,2	4	1,44	23,04	36	51,84	849,44	I35 lmq
30,5x61 nat	8,2	8	1,49	23,50	60	89,40	1430	I31 lmq
32,5x32,5 nat	8,2	14	1,55	22,00	69	102,12	1538	I31 lmq

MARTE BIANCO 60x60

GRES PORCELLANATO RETTIFICATO

rectified porcelain stoneware

UNI EN 14411 BIA GL

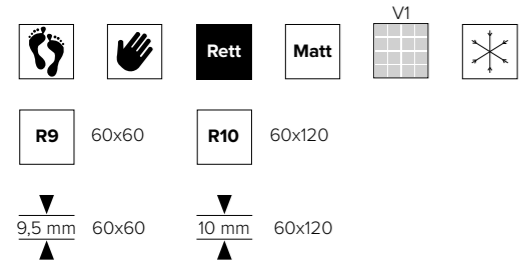

FORMATI

formats



PEZZI SPECIALI

special pieces



battiscopa 7,5x60
Y6 lpz

ICE



SAND

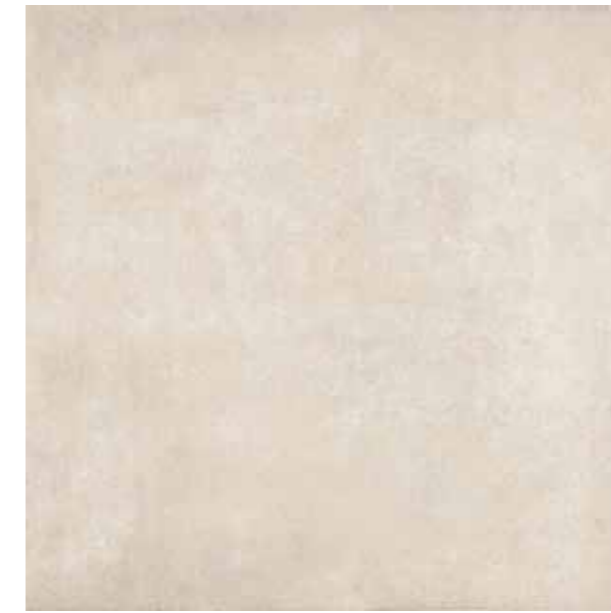

FOG

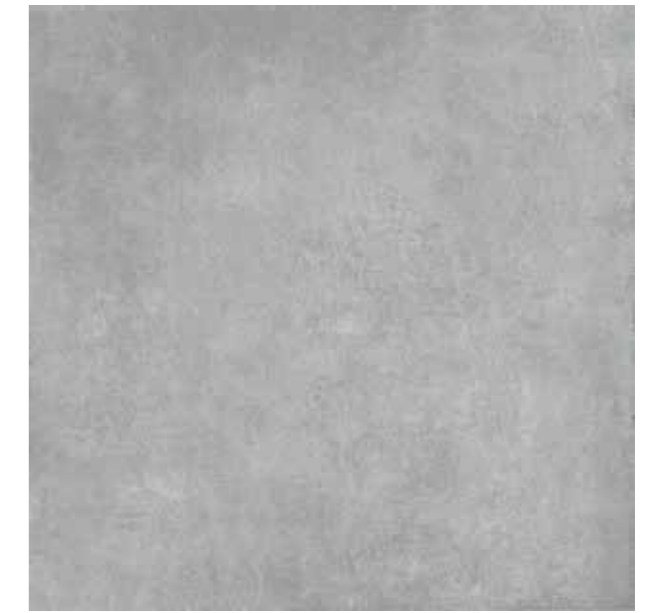

SMOKE

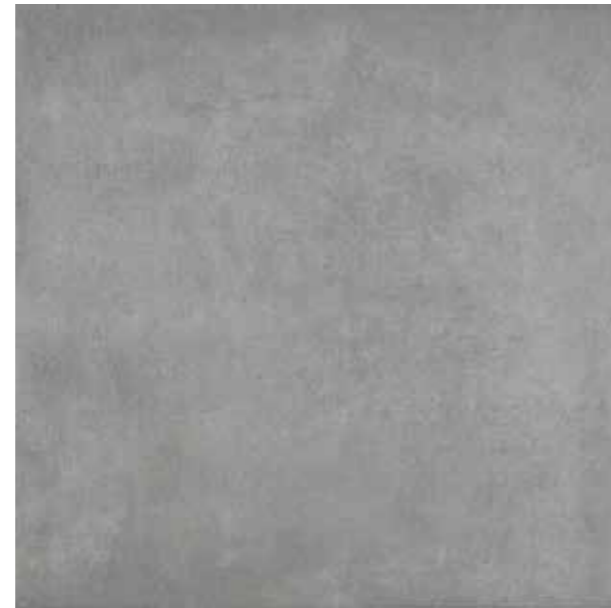

IMBALLI packing	$\frac{\blacktriangledown}{\text{mm}}$ \blacktriangle	PZ box	MQ box	KG box	BOX pallet	MQ pallet	KG pallet	CODICE PREZZO price code
60x120 rett	10	2	1,44	31,60	36	51,84	1140	C44 lmq
60x60 rett	9,5	3	1,08	22,66	40	43,20	907	C36 lmq

GRES PORCELLANATO RETTIFICATO

rectified porcelain stoneware

UNI EN 14411 BIA GL

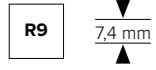

FORMATI

formats

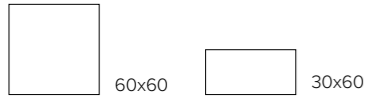

PEZZI SPECIALI

special pieces



battiscopa 7,5x60
Y6 lpz

TORTORA



BEIGE



GRIGO



COSTANZA GRIGIO 60x60

IMBALLI packing	mm	PZ box	MQ box	KG box	BOX pallet	MQ pallet	KG pallet	CODICE PREZZO price code
60x60 rett	7,4	4	1,44	20,59	32	46,08	824	X31 lmq
30x60 rett	7,4	8	1,44	20,59	40	57,60	825	X31 lmq

GRES PORCELLANATO RETTIFICATO

rectified porcelain stoneware

UNI EN 14411 BIA GL



R10 60x119,8 | 80,2x80,2
60x60 | 30x60

R11 60x60 | 30x60 **GRIP**

▼
9 mm
▲

60x119,8 | 80,2x80,2 | 60x60 | 30x60
60x60 | 30x60 **GRIP**



FORMATI

formats

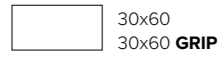
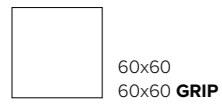

PEZZI SPECIALI

special pieces



battiscopa 7,5x60
Y6 lpz



ANTRACITE



PERLA



GRIGIO



BEIGE



RUGGINE



METALLICA ANTRACITE 60x60

IMBALLI packing	▼ mm ▲	PZ box	MQ box	KG box	BOX pallet	MQ pallet	KG pallet	CODICE PREZZO price code
80,2x80,2 rett	9	2	1,29	22,58	36	46,44	812,88	X38 Imq
60x60 rett 60x60 GRIP rett R11	9	4	1,44	23,33	32	46,08	774	X35 Imq
30x60 rett 30x60 GRIP rett R11	9	8	1,44	23,33	40	57,60	933	X35 Imq

DECORO FIORE 2 grafiche

RUGGINE

BEIGE

DECORO ESAGONO 2 grafiche



DECORO TROPICO 2 grafiche

PERLA

GRIGIO

ANTRACITE

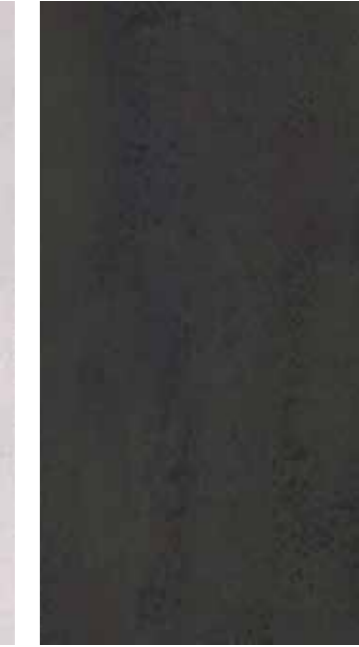

METALLICA RUGGINE 60x60 DECORO FIORE 60x119,8

IMBALLI packing	mm	PZ box	MQ box	KG box	BOX pallet	MQ pallet	KG pallet	CODICE PREZZO price code
60x119,8 rett	9	2	1,44	26,90	36	51,84	948,67	X42 Imq
60x119,8 decoro rett	9	2	1,44	26,90	36	51,84	948,67	X65 Imq



METALLICA GRIGIO 60x119,8 ANTRACITE 60x119,8 DECORO TROPICO 60x119,8

GRES PORCELLANATO RETTIFICATO

rectified porcelain stoneware

UNI EN 14411 BIA GL

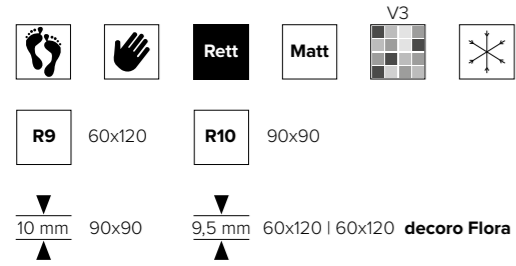

FORMATI

formats

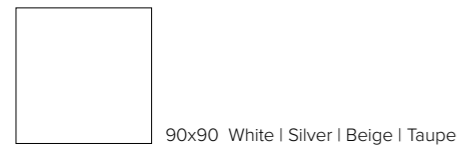

PEZZI SPECIALI

special pieces

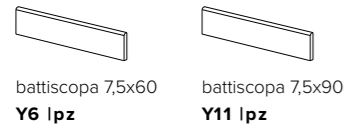



SATÈN PULPIS WHITE 90x90

WHITE



SILVER



BEIGE



TAUPE



IMBALLI packing	▼ mm ▲	PZ box	MQ box	KG box	BOX pallet	MQ pallet	KG pallet	CODICE PREZZO price code
90x90 rett	10	2	1,62	34,51	20	32,40	690	L55 Imq

WHITE



BEIGE



SILVER



ALMOND



TAUPE



FLORA COLD mix di grafiche random



FLORA WARM mix di grafiche random



SATÈN PULPIS SILVER 60x120 - Coffee Tables MOON Skytech by Decorunion

DECORI DISPONIBILI UNICAMENTE CON SOGGETTI MISCELATI RANDOM SENZA CONTINUITÀ DI GRAFICA.

Decors only available in random mixed subjects without graphic continuity.

IMBALLI packing	mm	PZ box	MQ box	KG box	BOX pallet	MQ pallet	KG pallet	CODICE PREZZO price code
60x120 rett	9,5	2	1,44	30,55	36	51,84	1100	C43 Imq
60x120 decoro rett	9,5	2	1,44	30,55	36	51,84	1100	I65 Imq

GRES PORCELLANATO RETTIFICATO

rectified porcelain stoneware

UNI EN 14411 BIA GL



Matt 60x120
escluso marquinia

Lux 60x120 | 60x60

$\frac{9 \text{ mm}}{\blacktriangle}$ 60x120

$\frac{8,5 \text{ mm}}{\blacktriangle}$ 60x60



FORMATI

formats

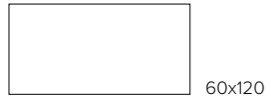

60x120



60x60

PEZZI SPECIALI

special pieces



battiscopa 75x60
Y8 lpz



CALACATTA | glossy | matt

60x120 | 8 grafiche
60x60 | 10 grafiche



CALACATTA GOLD | glossy | matt

60x120 | 8 grafiche
60x60 | 10 grafiche



DIVA CALACATTA 60x120 - Glossy

IMBALLI packing	▼ mm ▲	📦 PZ box	📦 MQ box	📦 KG box	📦 BOX pallet	📦 MQ pallet	📦 KG pallet	CODICE PREZZO price code
60x120 rett	9	2	1,44	29,70	30	43,20	905	G44 lmq
60x60 rett	8,5	4	1,44	29,70	32	46,08	965	G42 lmq



DIVA CALACATTA GOLD 60x120 - Glossy

IMBALLI packing	▼ mm ▲	📦 PZ box	📦 MQ box	📦 KG box	📦 BOX pallet	📦 MQ pallet	📦 KG pallet	CODICE PREZZO price code
60x120 rett	9	2	1,44	29,70	30	43,20	905	G44 lmq
60x60 rett	8,5	4	1,44	29,70	32	46,08	965	G42 lmq

AMANI BEIGE | glossy | matt

8 grafiche

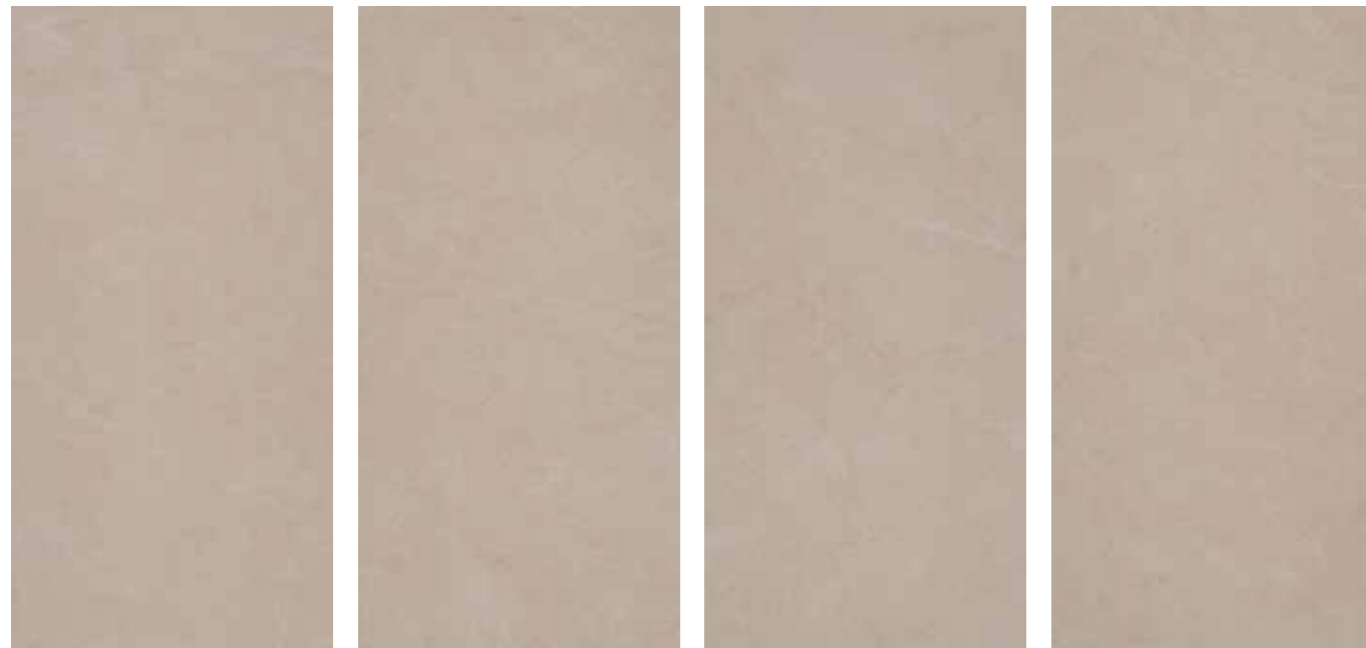

GOLDEN WHITE | glossy | matt

8 grafiche



DIVA AMANI BEIGE 60x120 - Glossy

IMBALLI packing	mm	PZ box	MQ box	KG box	BOX pallet	MQ pallet	KG pallet	CODICE PREZZO price code
60x120 rett	9	2	1,44	29,70	30	43,20	905	G44 Imq



DIVA GOLDEN WHITE 60x120 - Matt

IMBALLI packing	mm	PZ box	MQ box	KG box	BOX pallet	MQ pallet	KG pallet	CODICE PREZZO price code
60x120 rett	9	2	1,44	29,70	30	43,20	905	G44 Imq

BRECCIA WHITE | glossy | matt

8 grafiche



BRECCIA GREIGE | glossy | matt

8 grafiche



MARQUINIA GOLD BLACK | glossy

8 grafiche

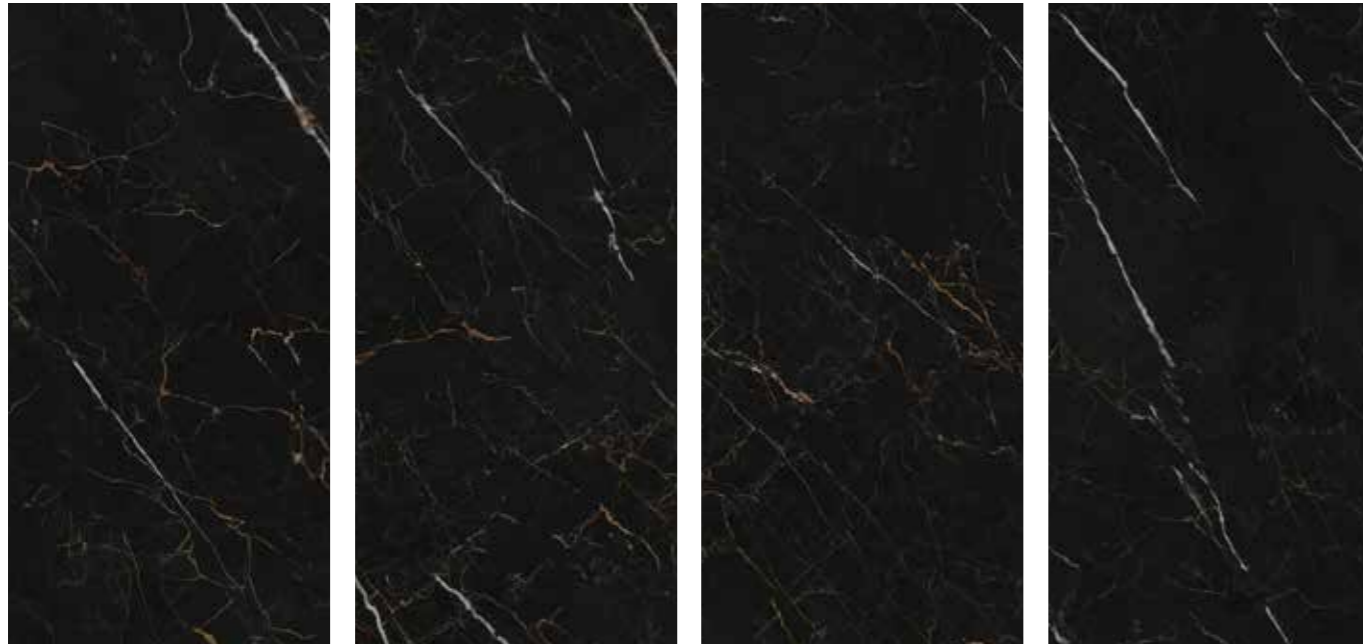

DIVA BRECCIA GREIGE 60x120 - Glossy

IMBALLI packing	▼ mm ▲	PZ box	MQ box	KG box	BOX pallet	MQ pallet	KG pallet	CODICE PREZZO price code
60x120 rett	9	2	1,44	29,70	30	43,20	905	G44 Imq
60x120 marquinia rett	9	2	1,44	29,70	30	43,20	905	G47 Imq

IMBALLI packing	▼ mm ▲	PZ box	MQ box	KG box	BOX pallet	MQ pallet	KG pallet	CODICE PREZZO price code
60x120 rett	9	2	1,44	29,70	30	43,20	905	G44 Imq

marble effect | effect marbre

GRES PORCELLANATO RETTIFICATO

rectified porcelain stoneware

UNI EN 14411 BIA GL

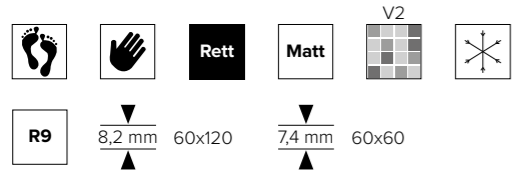

FORMATI

formats



PEZZI SPECIALI

special pieces



battiscopa 6,5x60

Y6 lpz

CALACATTA GRIGIO



CALACATTA BEIGE



CALACATTA

CALACATTA GRIGIO



DECORO LUNARIA GRIGIO



CALACATTA BEIGE



DECORO LUNARIA BEIGE



IMBALLI packing	mm	PZ box	MQ box	KG box	BOX pallet	MQ pallet	KG pallet	CODICE PREZZO price code
60x119,8 rett	8,2	2	1,44	23,33	42	60,48	995	X43 lmq
60x119,8 decoro rett	8,2	2	1,44	23,33	42	60,48	995	X65 lmq
60x60 rett	7,4	4	1,44	20,59	32	46,08	824	X33 lmq

CALACATTA GRIGIO 60x119,8 DECORO LUNARIA GRIGIO 60x119,8

wood effect | effect bois

GRES PORCELLANATO RETTIFICATO

rectified porcelain stoneware

UNI EN 14411 BIA GL

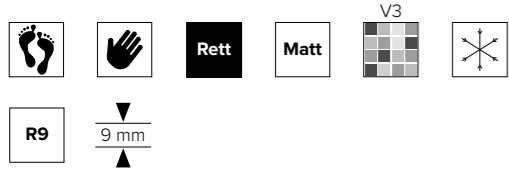

FORMATO

format



PEZZI SPECIALI

special pieces



battiscopa 7,5x60
Y6 lpz

*BATTISCOPIA COORDINATO
coordinated skyrting

GRIGIO



BIANCO



MIELE



MORO



IMBALLI packing	mm	PZ box	MQ box	KG box	BOX pallet	MQ pallet	KG pallet	CODICE PREZZO price code
61x61 rett	9	4	1,49	32,30	30	44,70	980	T38 lmq

GRES PORCELLANATO RETTIFICATO

rectified porcelain stoneware

UNI EN 14411 BIA GL

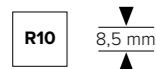

FORMATI

formats



30x120



20x120

PEZZI SPECIALI

special pieces



battiscopa 6,5x120

Y13 lpz

CONSIGLI DI POSA

laying advice

SI CONSIGLIA UNA POSA SFALSATA MASSIMA A 1/4 ONDE EVITARE PROBLEMI DI PLANARITÀ.

A staggered laying (max. 1/4) is highly recommended in order to avoid flatness problems.

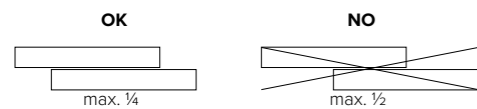



LINEWOOD ECO 30x120



LINEWOOD ELEGANT 20x120

ECO



NATURAL



ELEGANT



IMBALLI packing	▼ mm ▲	📦 PZ box	📦 MQ box	📦 KG box	📦 BOX pallet	📦 MQ pallet	📦 KG pallet	CODICE PREZZO price code
30x120 rett	8,5	4	1,44	28,00	36	51,84	1008	C40 Imq
20x120 rett	8,5	5	1,20	23,00	48	57,60	1104	C40 Imq

GRES PORCELLANATO RETTIFICATO

rectified porcelain stoneware

UNI EN 14411 BIA GL



R10 30x120
20x120

R11 20x120 **GRIP** Honey

▼
9,5 mm
▲



FORMATI

formats



30x120



20x120
20x120 **GRIP** Honey

PEZZI SPECIALI

special pieces



battiscopa 6,5x120
Y13 lpz

CONSIGLI DI POSA

laying advice

SI CONSIGLIA UNA POSA SFALSATA MASSIMA A 1/4 ONDE EVITARE PROBLEMI DI PLANARITÀ.

A staggered laying (max. 1/4) is highly recommended in order to avoid flatness problems.

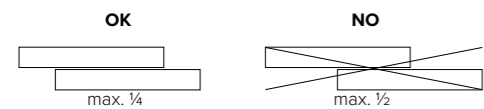



RAWOOD CREAM 20x120



RAWOOD NUT 20x120

CREAM



NUT



HONEY



IMBALLI packing	mm	PZ box	MQ box	KG box	BOX pallet	MQ pallet	KG pallet	CODICE PREZZO price code
30x120 rett	9,5	4	1,44	29,08	36	51,84	1064,58	S39 Imq
20x120 rett 20x120 GRIP rett R11	9,5	6	1,44	29,08	36	51,84	1064,58	S39 Imq

wood effect | effect bois

GRES PORCELLANATO RETTIFICATO

rectified porcelain stoneware

UNI EN 14411 BIA GL



FORMATO

format



20x120

PEZZI SPECIALI

special pieces



battiscopa 6,5x120

Y13 lpz



VALDIVIA BROWN 20x120

IMBALLI packing	mm	PZ box	MQ box	KG box	BOX pallet	MQ pallet	KG pallet	CODICE PREZZO price code
20x120 rett	9	4	0,92	18,50	40	36,80	740	C38 lmq

GREY



LIGHT



NATURAL



BROWN

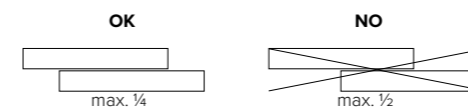

CONSIGLI DI POSA

laying advice

SI CONSIGLIA UNA POSA SFALSATA MASSIMA A 1/4 ONDE EVITARE PROBLEMI DI PLANARITÀ.

A staggered laying (max. 1/4) is highly recommended in order to avoid flatness problems.

GRES PORCELLANATO RETTIFICATO

rectified porcelain stoneware

UNI EN 14411 BIA GL

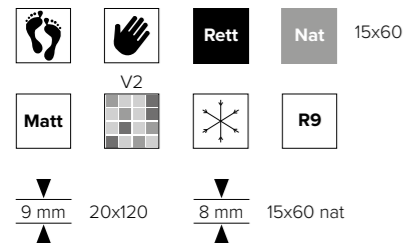

FORMATI

formats

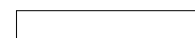

20x120



15x60 nat

PEZZI SPECIALI

special pieces



battiscopa 6,5x120

Y13 lpz

CONSIGLI DI POSA

laying advice

SI CONSIGLIA UNA POSA SFALSATA MASSIMA A 1/4 ONDE EVITARE PROBLEMI DI PLANARITÀ.

A staggered laying (max. 1/4) is highly recommended in order to avoid flatness problems.

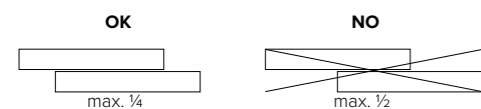



DECK MIELE 20x120



DECK NOCE 20x120

SBIANCATO



MIELE



NOCE



IMBALLI packing	▼ mm ▲	PZ box	MQ box	KG box	BOX pallet	MQ pallet	KG pallet	CODICE PREZZO price code
20x120 rett	9	6	1,44	28,50	36	51,84	1030	139 lmq
15x60 nat	8	11	1,00	17,20	80	80,00	1376	130 lmq

wood effect | effect bois

GRES PORCELLANATO NATURALE

natural porcelain stoneware

UNI EN 14411 BIA GL



R9 20x120 **R11** 20x120 **GRIP** Nocciolo | Ulivo

▼
9 mm
▲



FORMATO

format



20x120
20x120 **GRIP** Nocciolo | Ulivo

PEZZI SPECIALI

special pieces



battiscopa 6,5x120
Y13 lpz

CONSIGLI DI POSA

laying advice

SI CONSIGLIA UNA POSA SFALSATA MASSIMA A 1/4 ONDE EVITARE PROBLEMI DI PLANARITÀ.

A staggered laying (max. 1/4) is highly recommended in order to avoid flatness problems.

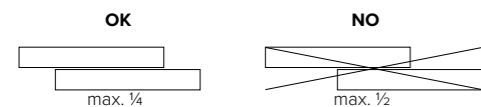

TEK



FRASSINO



OLD BOARDS FRASSINO 20x120

BETULLA



NOCCIOLO



ULIVO



LA FINITURA INVECCHIATA RAPPRESENTA CARATTERISTICA E PREGIO. LA FORTISSIMA STONALIZZAZIONE RENDE UNICO OGNI PAVIMENTO POSATO.

The aged finish is a precious feature of this floor. The strong colour shading makes every tile unique.

IMBALLI packing	▼ mm ▲	PZ box	MQ box	KG box	BOX pallet	MQ pallet	KG pallet	CODICE PREZZO price code
20x120 nat	9	6	1,44	31,68	36	51,84	1155	S38 Imq
20x120 GRIP nat R11	9	6	1,44	31,68	36	51,84	1155	S38 Imq

rustic floor tiles | sols rustique

GRES PORCELLANATO NATURALE

natural porcelain stoneware

UNI EN 14411 BIA GL

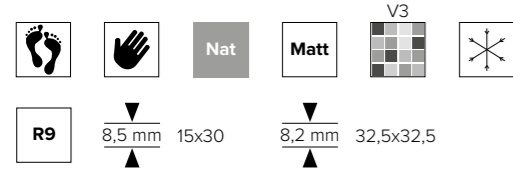

FORMATI

formats



PEZZI SPECIALI

special pieces



battiscopa 8x33
Y4 lpz

IMBALLI packing	mm	PZ box	MQ box	KG box	BOX pallet	MQ pallet	KG pallet	CODICE PREZZO price code
32,5x32,5 nat	8,2	14	1,48	21,00	69	102,12	1450	131 lmq
15x30 nat	8,5	22	0,99	17,90	84	83,16	1523	131 lmq

CAMPIELLO

ORO



RAME



BRONZO



rustic floor tiles | sols rustique

GRES PORCELLANATO NATURALE

natural porcelain stoneware

UNI EN 14411 BIA GL

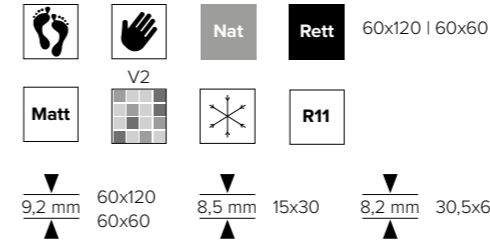

FORMATI

formats

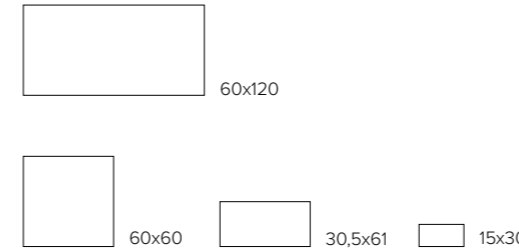

PEZZI SPECIALI

special pieces



battiscopa 8x33
Y4 lpz



elemento L monolitico **GRIP**
15x30x3 **Y16 lpz**

WHITE



GOLD



SILVER



IMBALLI packing	mm	PZ box	MQ box	KG box	BOX pallet	MQ pallet	KG pallet	CODICE PREZZO price code
60x120 rett	9,2	2	1,44	27,50	36	51,84	1010	142 lmq
60x60 rett	9,2	4	1,44	28,15	30	43,20	864,5	135 lmq
30,5x61 nat	8,2	8	1,49	23,50	60	89,40	1430	130 lmq
15x30 nat	8,5	22	0,99	17,90	84	83,16	1523	130 lmq

RIVER

MAGMA

GRES PORCELLANATO NATURALE

natural porcelain stoneware

UNI EN 14411 BIA GL

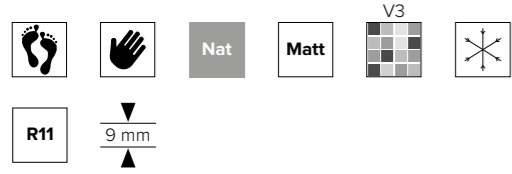

FORMATI

formats

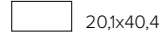

PEZZI SPECIALI

special pieces



battiscopa 8x40,4
Y6 lpz

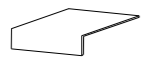

elemento L monolitico **GRIP**
15x30x3 **Y16 lpz**

GREY



BEIGE



PORFIDO RED



IMBALLI
packing



9



14



1,14



21,00



64



72,96



1345

CODICE
PREZZO
price code

131 lmq

20,1x40,4 nat

ETRURIA

GRES PORCELLANATO NATURALE

natural porcelain stoneware

UNI EN 14411 BIA GL

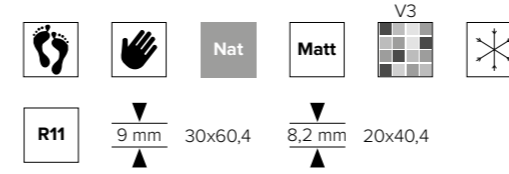

FORMATI

formats

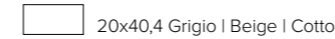
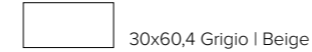

PEZZI SPECIALI

special pieces



battiscopa 8x40,4
Y6 lpz



battiscopa 6,5x60
Y6 lpz



elemento L monolitico **GRIP**
15x30x3 **Y16 lpz**

GRIGIO



BEIGE



COTTO



FORMATO 30X60,4 DISPONIBILE **SOLO** NEL COLORI GRIGIO E BEIGE.

Size 30x60,4 **only** available in the colours Grigio e Beige.

IMBALLI packing	mm	PZ box	MQ box	KG box	BOX pallet	MQ pallet	KG pallet	CODICE PREZZO price code
30x60,4 nat	9	7	1,30	22,23	40	52,00	889	X31 lmq
20x40,4 nat	8,2	18	146	23,64	48	70,08	1135	X31 lmq

GRES PORCELLANATO NATURALE

natural porcelain stoneware

UNI EN 14411 BIA GL

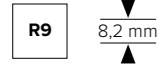

FORMATO

format



PEZZI SPECIALI

special pieces



battiscopa 6,5x45,5
Y6 lpz

CEMENTO ISLAND TAUPE



RIFLESSI TRAVERTINO GRIGIO



RIFLESSI TRAVERTINO BEIGE



CEMENTO ISLAND GRIGIO



CEMENTO ISLAND BEIGE



CEMENTO ISLAND AZZURRO



CEMENTO ISLAND VERDE



IMBALLI packing	mm	PZ box	MQ box	KG box	BOX pallet	MQ pallet	KG pallet	CODICE PREZZO price code
45,5x45,5 nat	8,2	8	1,66	26,30	48	79,68	1260	X30 lmq

GRES PORCELLANATO NATURALE

UNI EN 14411 BIA GL

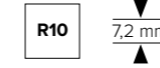

FORMATO

format



GHIACCIO

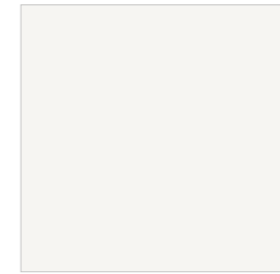

PANNA

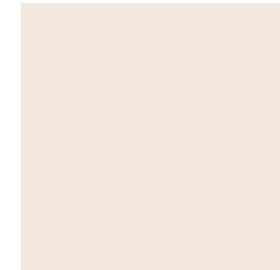

VERDE



GIALLO



GRIGIO



AZZURRO

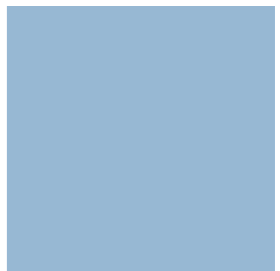

ARANCIO



IMBALLI packing	mm	PZ box	MQ box	KG box	BOX pallet	MQ pallet	KG pallet	CODICE PREZZO price code
20x20 nat	7,2	38	1,52	23,05	60	91,20	1496	E38 lmq

KLINKER

klinker

DIN EN 14411 GR.AL_p

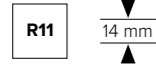

FORMATI

formats

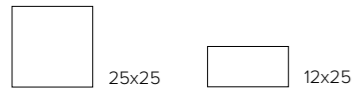

PEZZI SPECIALI

special pieces

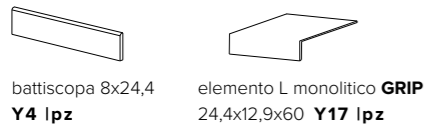

PER CONSUETUDINE INTERNAZIONALE, NEL KLINKER LA MISURA NOMINALE È DA INTENDERSI COMPRESIVA DI FUGA 8MM. LA CARATTERISTICA E IL PREGIO DI QUESTI PRODOTTI È LA FORTISSIMA STONALIZZAZIONE NATURALE. TOTALMENTE INGELIVO COTTO A 1330°C.

According to international standard, the nominal size of Klinker is considered inclusive of 8mm grout spacing. The peculiarity and the value of these materials is the very natural strong colour shading. TOTALLY FROST-PROOF FIRED AT 1330°C.

BLANCO

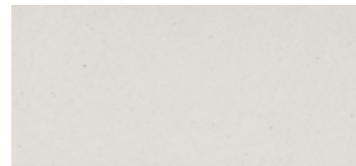

GRIS

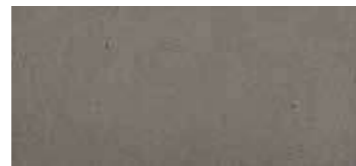

NATURAL

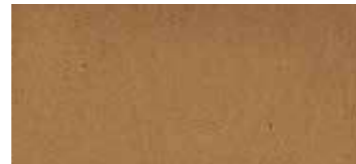

ROJO



KLINKER ROJO 12x25

IMBALLI packing	mm	PZ box	MQ box	KG box	BOX pallet	MQ pallet	KG pallet	CODICE PREZZO price code
25x25 nat	14	16	1,00	26,00	60	60,00	1560	K53 lmq
12x25 nat	14	16	0,50	24,80	120	60,00	1489	K53 lmq

SPC

stone polymer composite

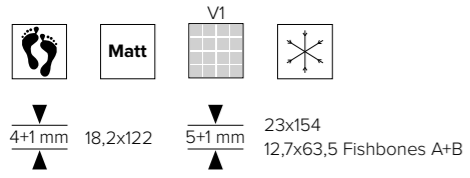

FORMATI

formats



23x154x5+1mm



18,2x122x4+1mm

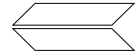

12,7x63,5x5+1mm
Fishbones A+B

PEZZI SPECIALI

special pieces

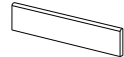

battiscopa
su richiesta | on request

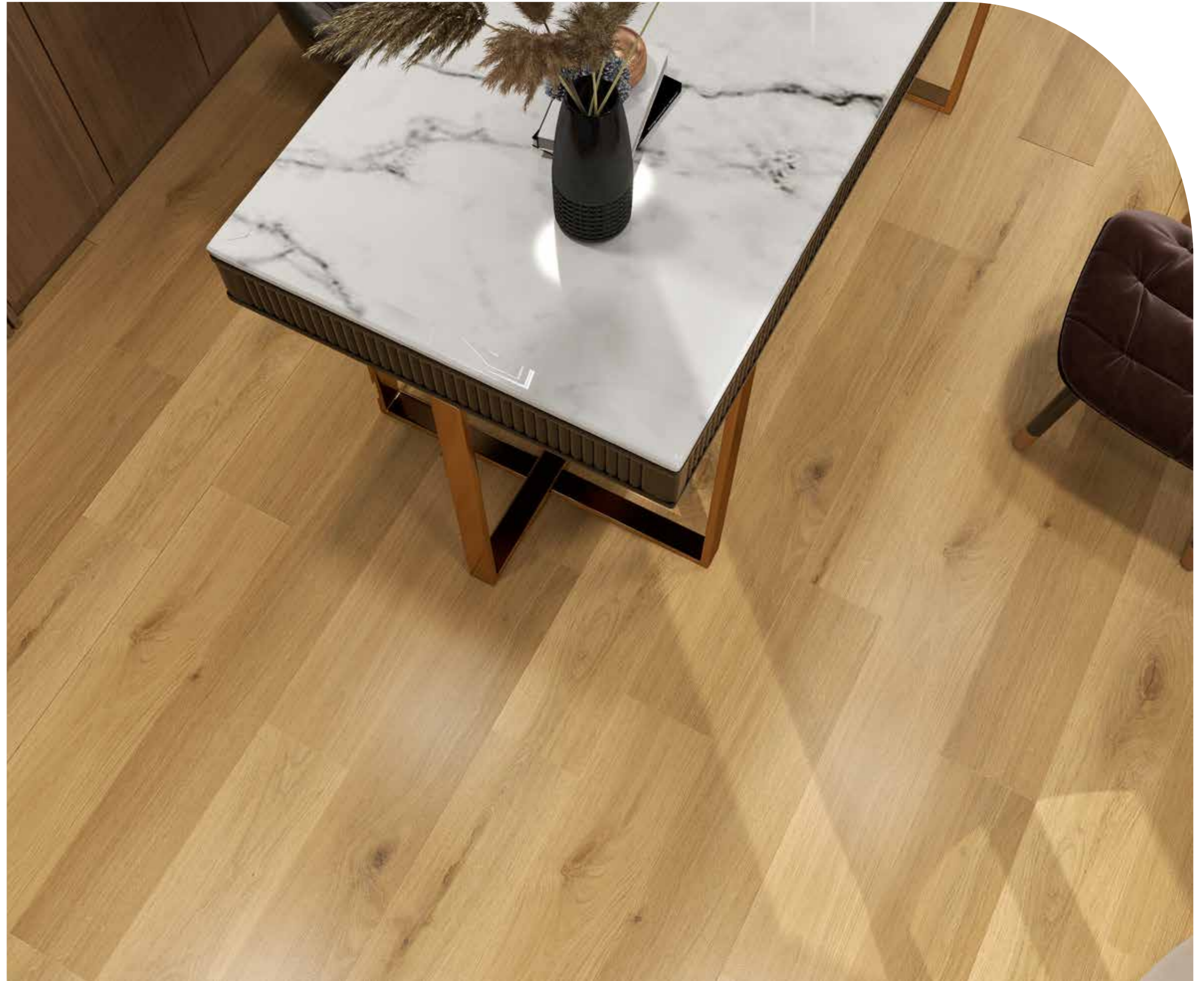

FOREST HONEY FISHBONES - posa

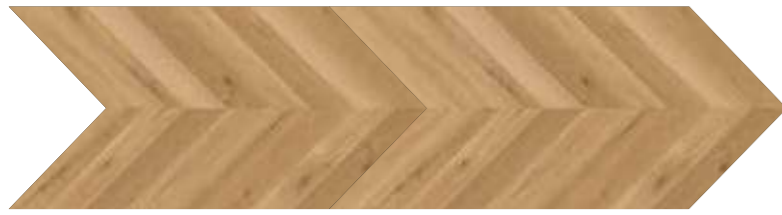

DREAM OAK FISHBONES - posa



FOREST HONEY A



FOREST HONEY B

DREAM OAK A



DREAM OAK B

FOREST HONEY



DREAM OAK



DREAM IVORY



FOREST TAUPE



SPC FOREST HONEY FISHBONES 12,7x63,5x5x1 mm

LA VENDITA DEL PRODOTTO FISHBONES È SUBORDINATA ALL'ACQUISTO DI **TIPO A** E **TIPO B** NELLE MEDESIME QUANTITÀ.

The sale of the Fishbones product is subject to the purchase of **Type A** and **Type B** in equal quantities.

IMBALLI packing	mm	PZ box	MQ box	KG box	BOX pallet	MQ pallet	KG pallet	CODICE PREZZO price code
23x154x5+1 mm	5+1	6	2,13	21,83	56	119,28	1262	G66 lmq
18,2x122x4+1 mm	4+1	10	2,22	18,20	64	142,08	1195	G57 lmq
12,7x63,5x5+1 mm fishbones	5+1	17	1,37	14,05	72	98,64	1041	G78 lmq

decorative style | style décoratif

GRES PORCELLANATO NATURALE

natural porcelain stoneware

UNI EN 14411 BIA GL

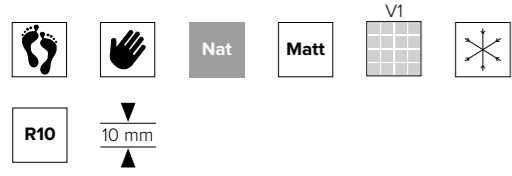

FORMATO

format

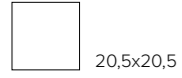

PAINT MÉLANGE - 25 soggetti

DECORI DISPONIBILI UNICAMENTE CON
GRAFICHE MISCELATE RANDOM MIX 25
SOGGETTI.

Decoration only available in 25 mixed subject.

BELLE EPOQUE

PAINT ICE



PAINT ELEGANCE



PAINT ROMBI



PAINT CUBI



PAINT SPLENDOR



PAINT GIGLIO



PAINT ROMANTICO



PAINT TRECCIA



PAINT CARDINALI



PAINT FIORE



PAINT MAIOLICA



BELLE EPOQUE PAINT CARDINALI 20,5x20,5

IMBALLI packing	mm	PZ box	MQ box	KG box	BOX pallet	MQ pallet	KG pallet	CODICE PREZZO price code
20,5x20,5 nat	10	16	0,6725	14,55	48	32,28	700	B72 lmq



BELLE EPOQUE ELEMENT BAROQUE 20,5x20,5



BELLE EPOQUE ELEMENT ARABESQUE 20,5x20,5

ELEMENT BIANCO

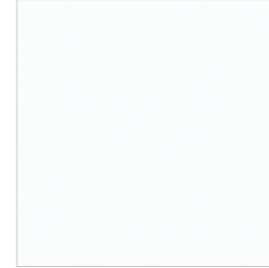

ELEMENT GRIGIO



ELEMENT NERO



ELEMENT BAROQUE



ELEMENT GEOMETRY



ELEMENT OPTICAL

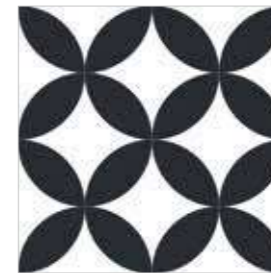

ELEMENT LILY



ELEMENT FLOWER



ELEMENT STAR

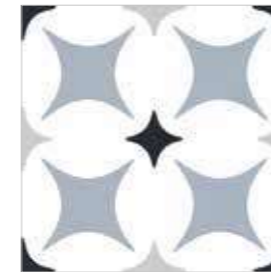

ELEMENT ARABESQUE



ELEMENT SQUARE



BELLE EPOQUE ELEMENT FLOWER 20,5x20,5

IMBALLI packing	mm	PZ box	MQ box	KG box	BOX pallet	MQ pallet	KG pallet	CODICE PREZZO price code
20,5x20,5 nat	10	16	0,6725	14,55	48	32,28	700	B72 lmq

STILE
DECORATIVO

decorative style | style décoratif

GRES PORCELLANATO NATURALE

natural porcelain stoneware

UNI EN 14411 BIA GL

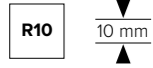

FORMATO

format

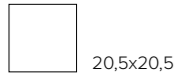

BELLE EPOQUE MIX



BELLE EPOQUE MIX AMARCORD MIX
20,5x20,5

AMARCORD MIX - 36 soggetti



MISTIQUE MIX - 30 soggetti



AMARCORD MIX

DECORI DISPONIBILI UNICAMENTE CON
GRAFICHE MISCELATE RANDOM MIX 36
SOGGETTI.

Decoration only available in 36 mixed subject.

MISTIQUE MIX

DECORI DISPONIBILI UNICAMENTE CON
GRAFICHE MISCELATE RANDOM MIX 30
SOGGETTI.

Decoration only available in 30 mixed subject.

RE-STYLE MIX

DECORI DISPONIBILI UNICAMENTE CON GRAFICHE
MISCELATE RANDOM MIX 20 SOGGETTI.

Decoration only available in 20 mixed subject.

RE-STYLE MIX WHITE - 20 soggetti



RE-STYLE MIX BLACK - 20 soggetti



IMBALLI
packing

20,5x20,5 nat



10



16



0,6725



14,55



48



32,28



700

CODICE
PREZZO
price code

B72 lmq

GRES PORCELLANATO NATURALE

natural porcelain stoneware

UNI EN 14411 BIA GL

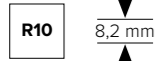

FORMATO

format





D.A.D.À BEAU 20x20



D.A.D.À ÉTRANGE 20x20

NEUTRE



BEAU



FORT

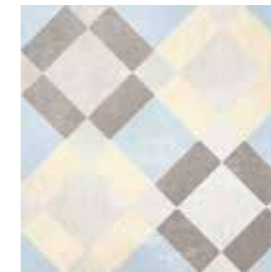

DÈTERMINÈ



INTENSE



FOU



SINCÈRE



ÉTRANGE



IDÈAL



NEW MODERNE



NEW MISTÉRIEUX



NEW PROFOND



NEW PASSIONNÈ



IMBALLI packing	mm	PZ box	MQ box	KG box	BOX pallet	MQ pallet	KG pallet	CODICE PREZZO price code
20x20 nat	8,2	34	1,36	22,03	48	65,28	1058	X50 Imq

decorative style | style décoratif

GRES PORCELLANATO NATURALE

natural porcelain stoneware

UNI EN 14411 BIA GL



R10
8,2 mm



FORMATO

format

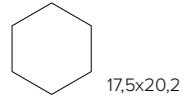

PEZZI SPECIALI

special pieces



battiscopa 7,5x60
Y6 lpz

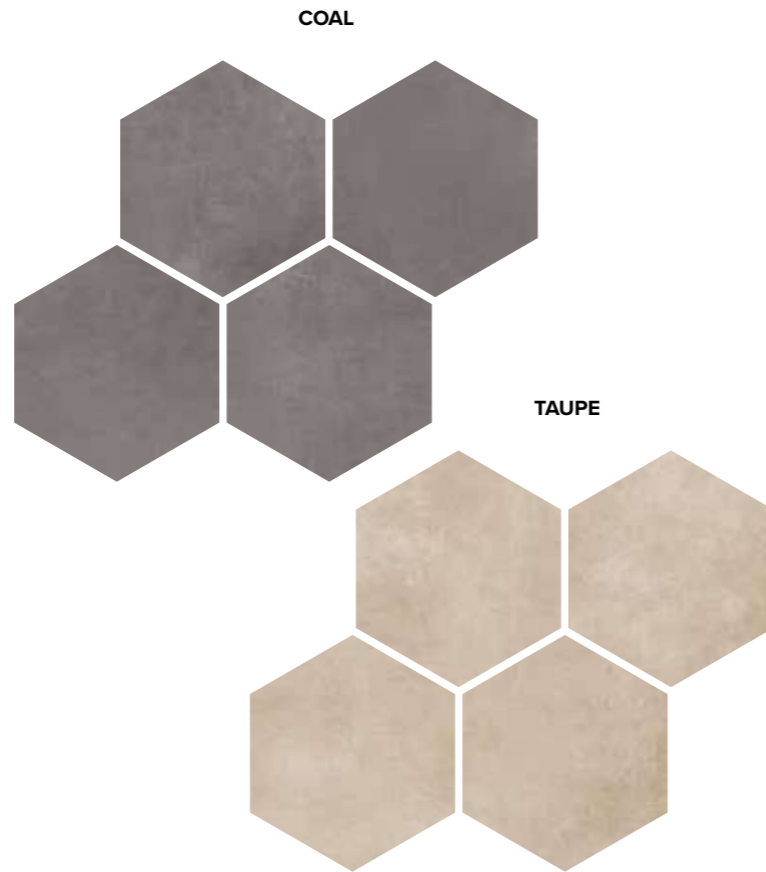

ESAGONE WB TAUPE 17,5X20,2 WB TAUPE 30x60 WB TAUPE 60x60

**WB
ESAGONE**

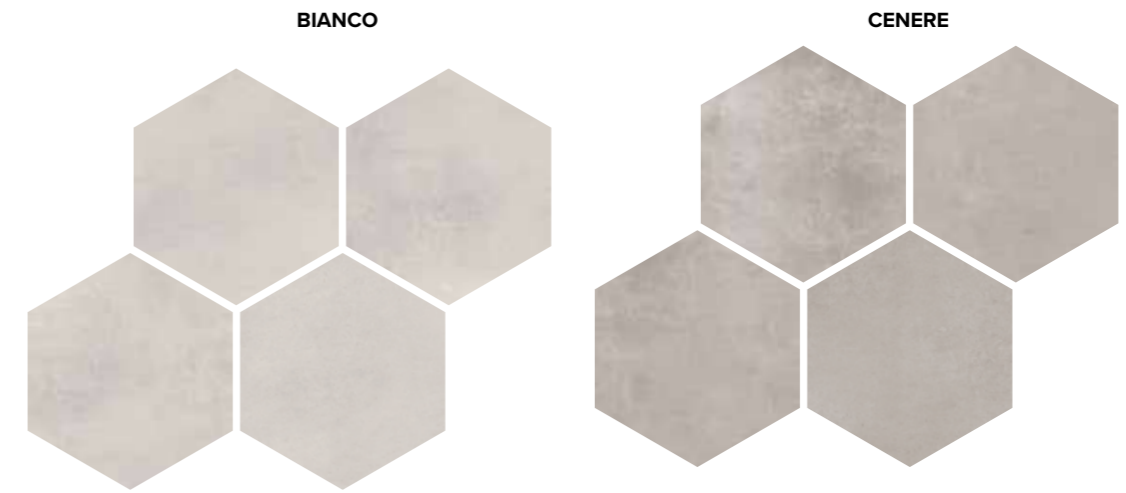

ESAGONE WB CENERE 17,5X20,2 WB CENERE 60x120

IMBALLI packing	mm	PZ box	MQ box	KG box	BOX pallet	MQ pallet	KG pallet	CODICE PREZZO price code
17,5x20,2 esagona nat R10	8,2	25	0,714	12,76	80	5712	1021	J87 lmq

decorative style | style décoratif

GRES PORCELLANATO NATURALE

natural porcelain stoneware

UNI EN 14411 BIA GL

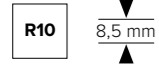

FORMATO

format

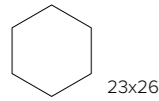

MACBA TERRACOTA



MACBA BLUE



MACBA COCONUT MILK



MACBA OBSIDIANA

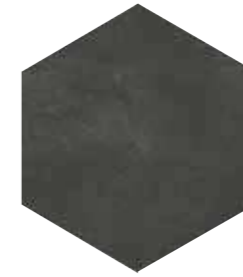

MACBA GREY



MACBA PALLADIUM

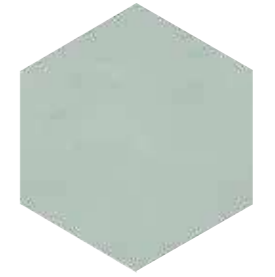

MACBA QUARTZ



ESAGONE KLEN MACBA QUARTZ 23x26

**KLEN
ESAGONE**



ESAGONE KLEN MACBA PALLADIUM 23x26

IMBALLI packing	mm	PZ box	MQ box	KG box	BOX pallet	MQ pallet	KG pallet	CODICE PREZZO price code
23x26 esagona nat R10	8,5	16	0,75	14,18	65	48,75	922	J87 lmq

decorative style | style décoratif

GRES PORCELLANATO NATURALE

natural porcelain stoneware

UNI EN 14411 BIA GL



8,7 mm



FORMATO

format

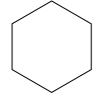

13,9x16



MARRAKASH ESA BLUE 13,9x16 **ESA TURQUESA** 13,9x16

MARRAKASH ESAGONE

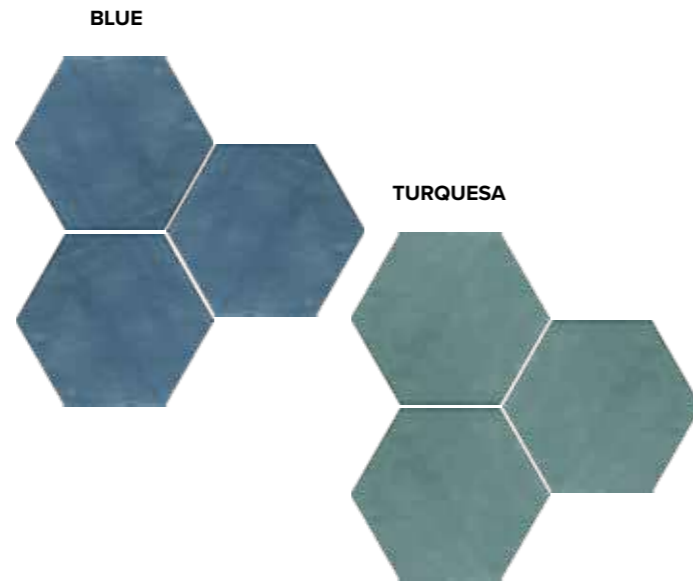

MARRAKASH ESA PEARL 13,9x16 **ESA GREY** 13,9x16 **ESA BLACK** 13,9x16



IMBALLI packing	mm	PZ box	MQ box	KG box	BOX pallet	MQ pallet	KG pallet	CODICE PREZZO price code
19,3x16 esagona nat	8,7	20	0,33	8,00	105	35,00	840	J78 Imq

decorative style | style décoratif

BICOTTURA PASTA BIANCA

white body double firing

UNI EN 14411 BIII GL

 **Nat**
 **Lux** 13x13
 **Matt** 13,9x16 **esagona**



FORMATI

formats

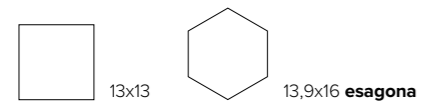

MARRAKASH BLUE 13x13 **ESA BLUE** 13,9x16

MARRAKASH

PEARL



GREY



BLACK

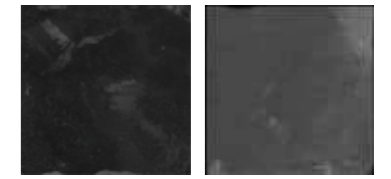

AQUA



BLUE

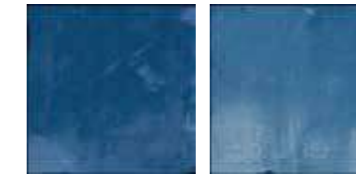

TURQUESA



GRES PORCELLANATO NATURALE

natural porcelain stoneware

Marrakash Esagone

pag.110

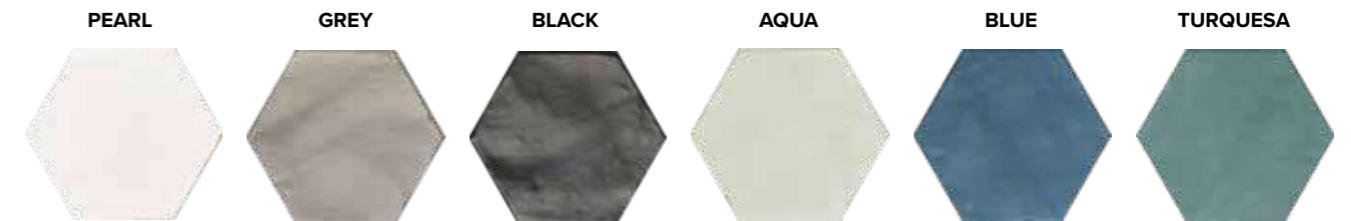

MARRAKASH PEARL 13x13 **ESA PEARL** 13,9x16

IMBALLI packing	mm	PZ box	MQ box	KG box	BOX pallet	MQ pallet	KG pallet	CODICE PREZZO price code
13x13	9,5	30	0,50	8,00	114	57,80	910	J90 lmq
13,9x16 esagona nat	8,7	20	0,33	8,00	105	35,00	840	J78 lmq

decorative style | style décoratif

GRES PORCELLANATO NATURALE

natural porcelain stoneware

UNI EN 14411 BIA GL



FORMATO

format

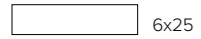

Rawood

pag.68



COBALTO posa 4 pezzi

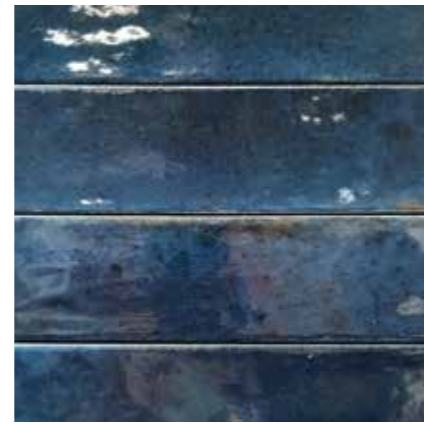

BIANCO posa 4 pezzi



GRIGIO posa 4 pezzi



NERO posa 4 pezzi

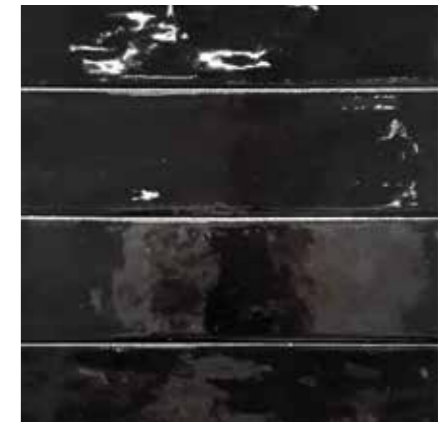

CARAIBI posa 4 pezzi



GEMME CARAIBI 6x25

GEMME



GEMME GRIGIO 6x25

IMBALLI packing	mm	PZ box	MQ box	KG box	BOX pallet	MQ pallet	KG pallet	CODICE PREZZO price code
6x25	9	50	0,75	14,50	84	63,00	1232	D70 lmq

BICOTTURA

double firing

UNI EN 14411 BIII GL



FORMATO

format



New Carioca

pag.87



BIANCO



GRIS



MARFIL



NEGRO



CREMA



PISCINA



LOFT PISCINA 10x30

IMBALLI packing	mm	PZ box	MQ box	KG box	BOX pallet	MQ pallet	KG pallet	CODICE PREZZO price code
10x30	8	34	1,02	14,30	87	88,83	1254	V42 Imq

BICOTTURA

double firing

UNI EN 14411 BIII GL



FORMATO

format



New Carioca

pag.87



BIANCO

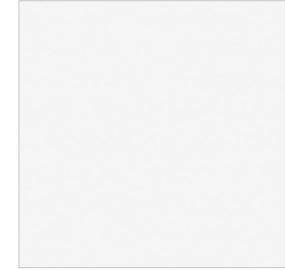

NERO



MARFIL

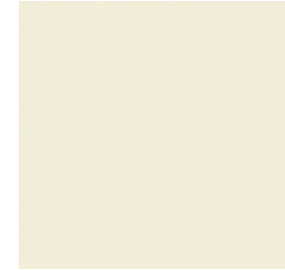

GRIS



PISTACHO



AZUL CELESTE

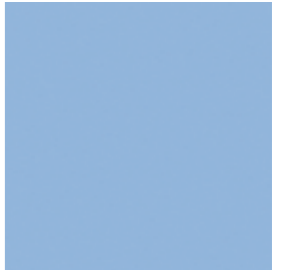

NARANJA



SOL



IMBALLI packing	mm	PZ box	MQ box	KG box	BOX pallet	MQ pallet	KG pallet	CODICE PREZZO price code
20x20 bianco marfil gris azul celeste	6,8	25	1,00	12,80	96	96,00	1250	V34 Imq
20x20 naranja pistacho negro	6,8	25	1,00	12,80	96	96,00	1250	V50 Imq
20x20 sol	6,8	25	1,00	12,80	96	96,00	1250	V69 Imq

MURETTO BRICK

GRES PORCELLANATO NATURALE

natural porcelain stoneware

UNI EN 14411 BIA GL

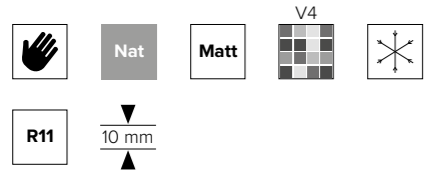

FORMATO

format

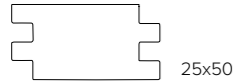

ASPEN



MANHATTAN



CHICAGO



NEW YORK



IMBALLI packing	mm	PZ box	MQ box	KG box	BOX pallet	MQ pallet	KG pallet	CODICE PREZZO price code
25x50	10	8	1,00	17,20	48	48,00	850	H43 Imq

MURETTO 3D

GRES PORCELLANATO NATURALE

natural porcelain stoneware

UNI EN 14411 BIA GL

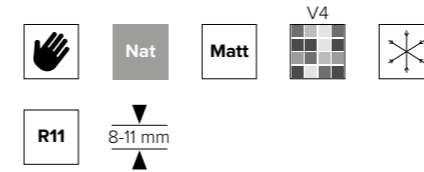

FORMATO

format



GREY



BEIGE



MURETTO 3D BEIGE 16x40

IMBALLI packing	mm	PZ box	MQ box	KG box	BOX pallet	MQ pallet	KG pallet	CODICE PREZZO price code
16x40	8-11	14	0,90	16,40	65	58,50	1080	D39 Imq

decorative style | style décoratif

GRES PORCELLANATO NATURALE

natural porcelain stoneware

UNI EN 14411 BIA GL

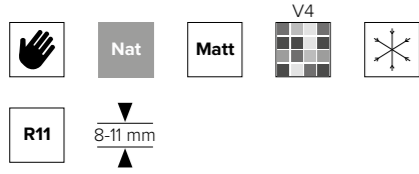

FORMATO

format



GREY



SAND



BROWN



MURETTO WALL BROWN 16x40

MURETTO WALL

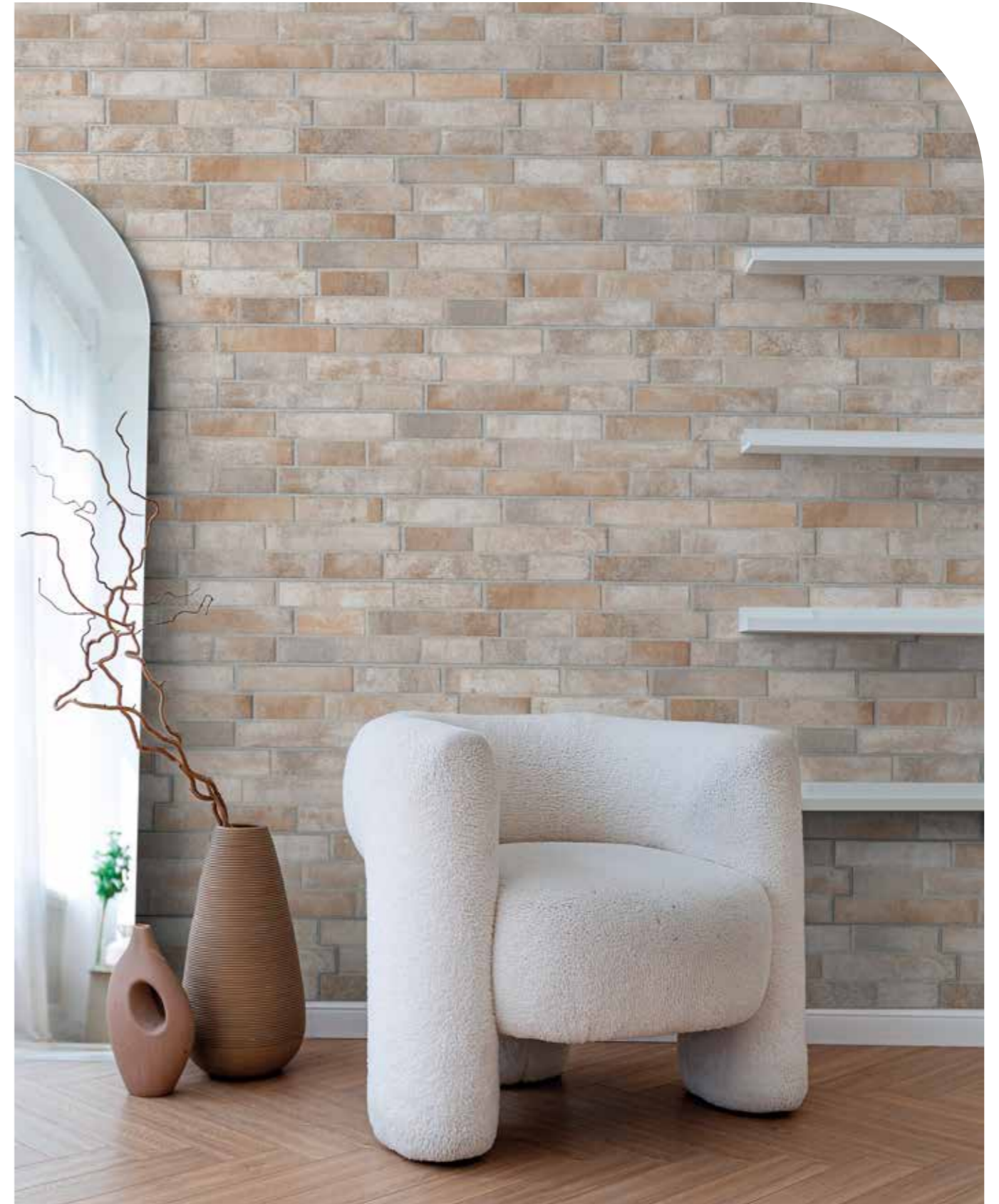

MURETTO WALL SAND 16x40

IMBALLI packing	mm	PZ box	MQ box	KG box	BOX pallet	MQ pallet	KG pallet	CODICE PREZZO price code
16x40	8-11	14	0,96	20,40	60	57,60	1240	D39 lmq

GRES PORCELLANATO RETTIFICATO

rectified porcelain stoneware

UNI EN 14411 BIA GL

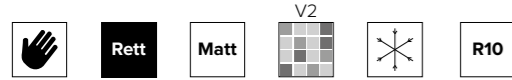

9,5 mm Flora Cold | Flora Warm

9 mm Fiore | Tropico | Esagono
Foglie | Selva



FORMATI

formats



SERIE IN ABBINAMENTO

matching series

Metallica | 60x119,8 Fiore | Tropico | Esagono | Foglie | Selva
pag.40

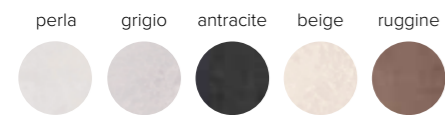

Calacatta | 60x119,8 Fiore | Tropico | Esagono | Foglie | Selva
pag.60

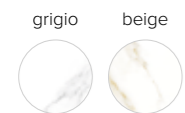

Satèn Pulpis | 60x120 Flora Cold | Flora Warm
pag.46



DECORO FIORE 60x119,8

DECORO FIORE 2 grafiche



DECORO ESAGONO 2 grafiche



DECORO TROPICO 2 grafiche



DECORO LUNARIA GRIGIO



DECORO LUNARIA BEIGE



FOGLIE 2 grafiche



SELVA 2 grafiche



IMBALLI packing	mm	PZ box	MQ box	KG box	BOX pallet	MQ pallet	KG pallet	CODICE PREZZO price code
60x119,8 Fiore Tropico Esagono Foglie Selva rett	9	2	1,44	29,60	36	51,84	948,67	X65 Imq

DECORO TROPICO 60x119,8

FLORA WARM mix di grafiche random



FLORA COLD mix di grafiche random



SATÈN PULPIS DECORO FLORA WARM 60x120



SATÈN PULPIS DECORO FLORA COLD 60x120

IMBALLI packing	▼ mm ▲	PZ box	MQ box	KG box	BOX pallet	MQ pallet	KG pallet	CODICE PREZZO price code
60x120 Flora Cold Flora Warm rett	9,5	2	1,44	27,50	36	51,84	1010	165 lmq

BICOTTURA PASTA BIANCA

white body double firing

UNI EN 14411 BIII GL



Rett

Matt

oh la la white
ole white
mama mia white

Lux

oh yeah white

10 mm



FORMATO

format



40x120 rett



SILK OLE WHITE 40x120

IMBALLI
packing

40x120



10



PZ box

3



MQ box

1,44



KG box

28,00



BOX pallet

20



MQ pallet

28,80



KG pallet

560

CODICE
PREZZO
price code

J63 Imq

OH LA LA WHITE

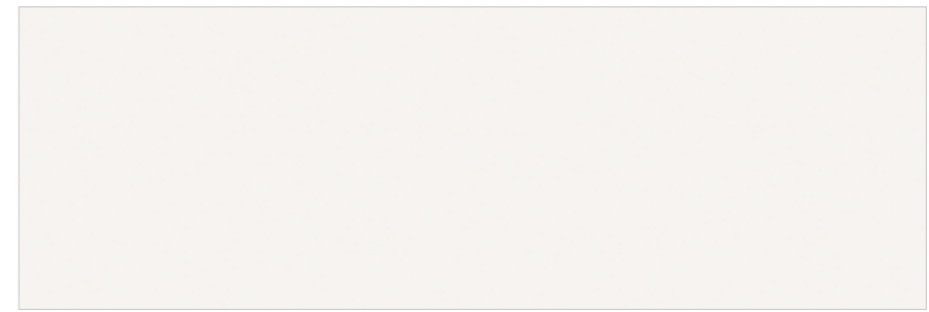

OLE WHITE



MAMA MIA WHITE



OH YEAH WHITE

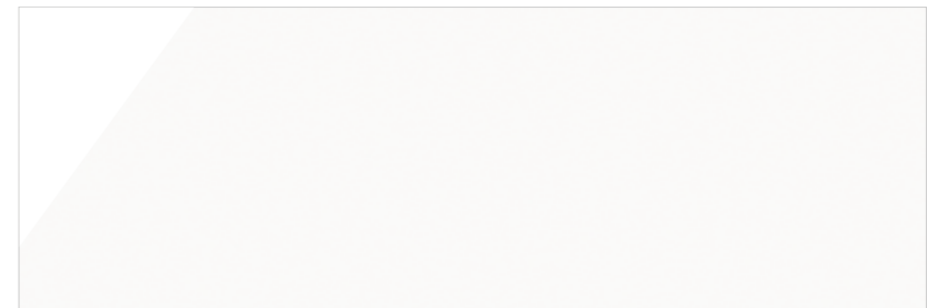

Rawood
pag.68

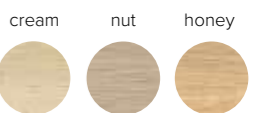

cream

nut

honey

BICOTTURA PASTA BIANCA

white body double firing

UNI EN 14411 BIII GL



FORMATO

format



BOISERIE FABLES BEIGE 30x90 **BOISERIE BLANCO** 30x90 **MOLDURA BLANCO** 5x30 **ZOCALO BLANCO** 15,8x30 **RAWOOD HONEY** 20x120

IMBALLI packing	mm	PZ box	MQ box	KG box	BOX pallet	MQ pallet	KG pallet	CODICE PREZZO price code
30x90	9	5	1,35	24,30	63	85,05	1530	J61 lmq

TOURS EAU



FABLES EAU



BLOIS EAU



TOURS BEIGE



FABLES BEIGE



BOISERIE BLANCO



MOLDURA BLANCO



ZOCALO BLANCO

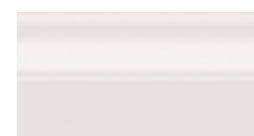

PEZZI SPECIALI

special pieces

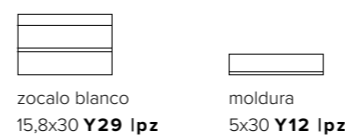

zocalo blanco
15,8x30 **Y29 lpz**

moldura
5x30 **Y12 lpz**

Rawood

pag.68

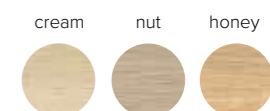

cream

nut

honey

BICOTTURA PASTA BIANCA

white body double firing

UNI EN 14411 BIII GL



Nat

Matt

9 mm

8,5 mm 23x26 esagona



FORMATI

formats



25x75



23x26 esagona

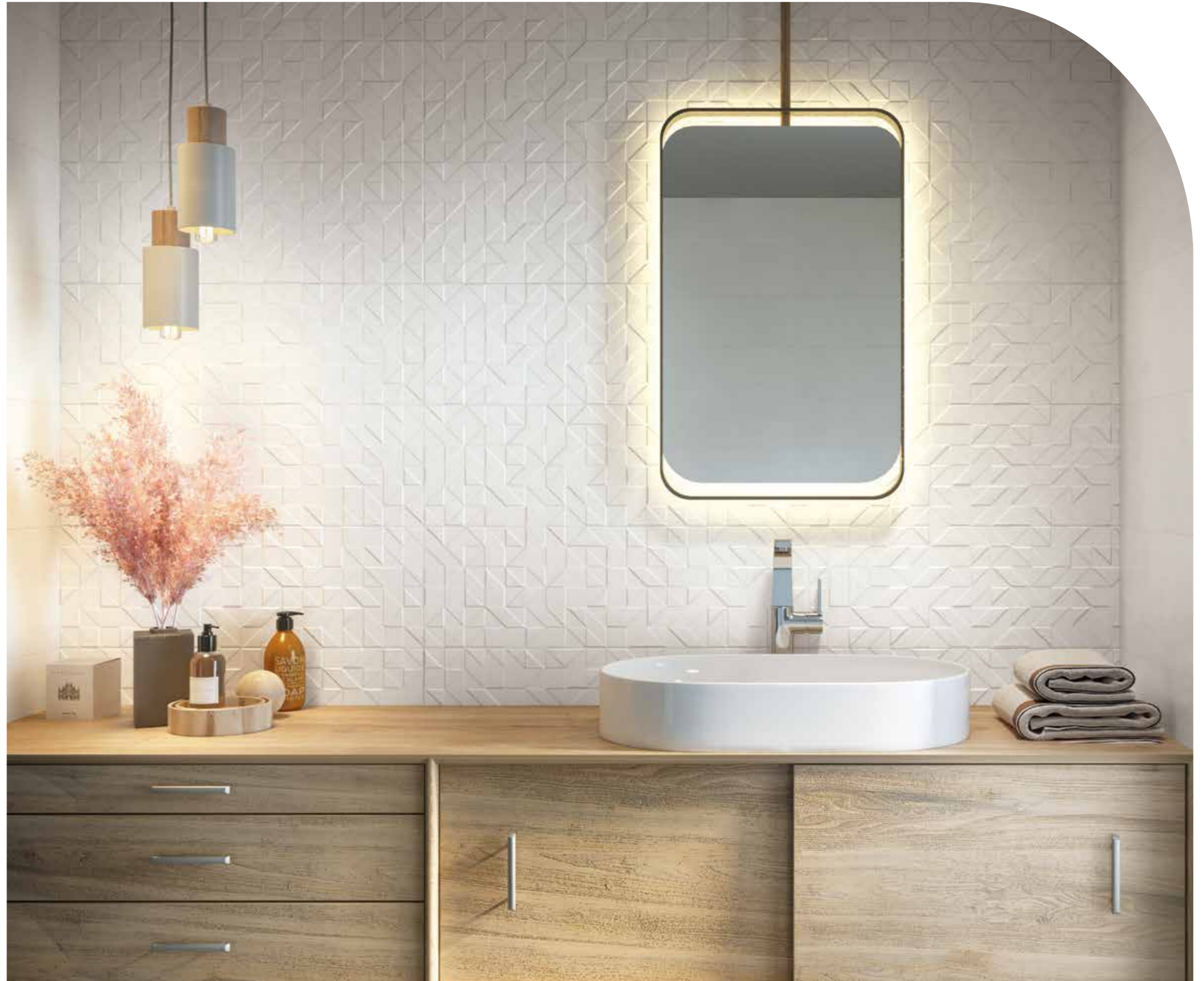

DECORO KLEN 2 soggetti



LIN COCONUT MILK



KLEN PALLADIUM 25x75 DECORO KLEN 25x75 DECK MIELE 20x120

IMBALLI packing	mm	PZ box	MQ box	KG box	BOX pallet	MQ pallet	KG pallet	CODICE PREZZO price code
25x75 fondi 3D gamy rett	9	7	1,31	20,00	48	62,88	960	J49 lmq
25x75 coconut	9	7	1,31	20,00	48	62,88	960	J61 lmq
25x75 decoro	9	4	0,75	10,00	-	-	-	Y55 lpz
23x26 esagona nat R10	8,5	16	0,75	14,18	65	48,75	922	J87 lmq

COCONUT MILK



BLUE



PALLADIUM



GREY



GAMY COCONUT MILK

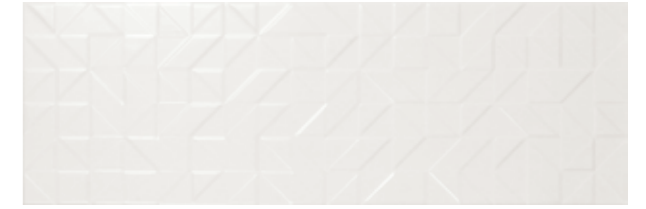

GAMY BLUE



GAMY PALLADIUM



GRES PORCELLANATO NATURALE

natural porcelain stoneware

UNI EN 14411 BIA GL

ESAGONA MACBA pag.108



Wb
pag.28

Deck
pag.74



BICOTTURA PASTA BIANCA

white body double firing

UNI EN 14411 BIII GL



Nat

matt



FORMATO

format



25x75



FASHION ICE 25x75 CEMENTINA GREY 25x75

IMBALLI packing	mm	PZ box	MQ box	KG box	BOX pallet	MQ pallet	KG pallet	CODICE PREZZO price code
25x75	10	7	1,31	18,60	45	58,95	840	M41 lmq
25x75 decoro	10	7	1,31	18,60	45	58,95	840	M43 lmq

ICE

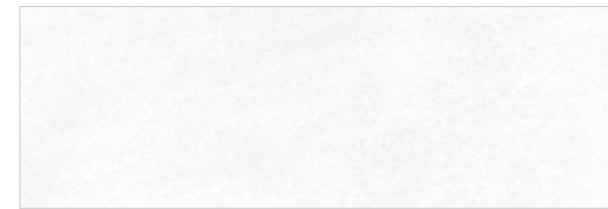

SAND

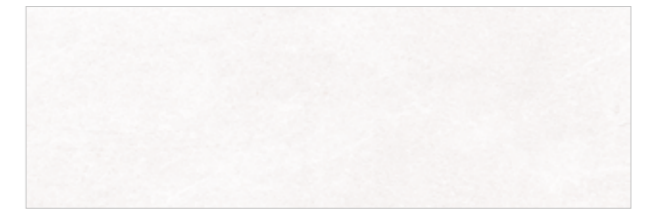

GREY



BEIGE



CEMENTINA GREY 3 grafiche



CEMENTINA BEIGE 3 grafiche



MURETTO GREY



MURETTO BEIGE



DECO MIX FREDDO 4 grafiche



DECO MIX CALDO 4 grafiche



Old Boards
pag.78

Genesi
pag.36

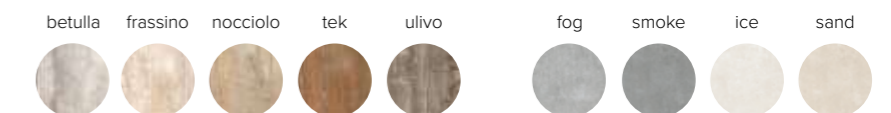

BICOTTURA

double firing

UNI EN 14411 BIII GL



Nat

matt



FORMATO

format



25x60



VIVA NEUTRO 25x60 VIVA GRIGIO 25x60 VIVA DECORO ROMANTICA 25x60 VIVA MURETTO GRIGIO 25x60

IMBALLI packing	mm	PZ box	MQ box	KG box	BOX pallet	MQ pallet	KG pallet	CODICE PREZZO price code
25x60	8	10	1,50	19,20	48	72,00	922	M31 lmq
25x60 muretto decoro	8	10	1,50	19,20	48	72,00	922	M32 lmq

NEUTRO



NEUTRO



GRIGIO



BEIGE



MURETTO GRIGIO 4 grafiche



MURETTO BEIGE 4 grafiche



DECORO ROMANTICA



DECORO FOGLIA



Line Cement

pag.30

Rawood

pag.68

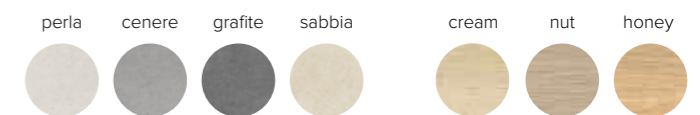

BICOTTURA

double firing

UNI EN 14411 BIII GL



Nat

matt

8 mm



FORMATO

format



25x60



MALDIVE NEUTRO 25x60 **MALDIVE MURETTO BEIGE** 25x60 **MALDIVE DECO** 25x60 **VIVO ROVERE MIELE** 20,2x121,9

IMBALLI packing	mm	PZ box	MQ box	KG box	BOX pallet	MQ pallet	KG pallet	CODICE PREZZO price code
25x60	8	10	1,50	19,20	48	72,00	922	M31 lmq
25x60 muretto decoro	8	10	1,50	19,20	48	72,00	922	M32 lmq

MALDIVE

NEUTRO

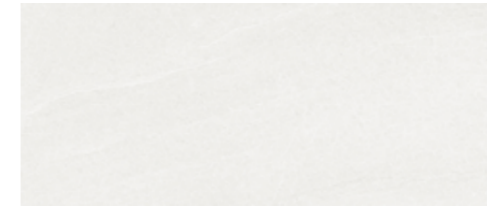

NEUTRO

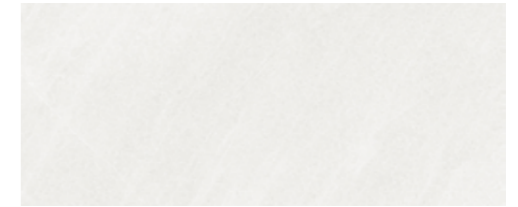

GRIGIO



BEIGE



DECO MIX 4 grafiche



DECO 4 grafiche



MURETTO GRIGIO 4 grafiche



MURETTO BEIGE 4 grafiche



Prestige
pag.6

Rawood
pag.68

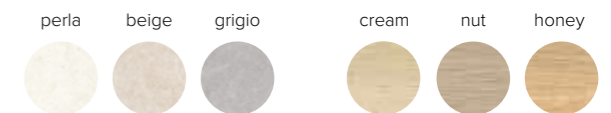

BICOTTURA

double firing

UNI EN 14411 BIII GL



Nat

matt



FORMATO

format



25x60



VANITY BIANCO 25x60 VANITY AZZURRO 25x60 DECO 25x60

IMBALLI packing	mm	PZ box	MQ box	KG box	BOX pallet	MQ pallet	KG pallet	CODICE PREZZO price code
25x60	8	10	1,50	19,20	48	72,00	922	M31 lmq
25x60 muretto decoro	8	10	1,50	19,20	48	72,00	922	M32 lmq

BIANCO



GRIGIO



AZZURRO



BEIGE

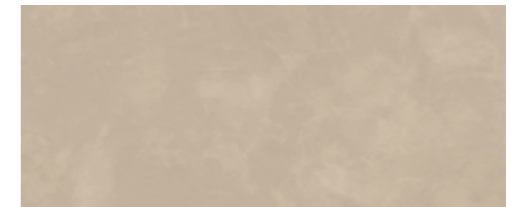

MURETTO GRIGIO AZZURRO 3 grafiche



MURETTO BEIGE GRIGIO 3 grafiche



DECO 3 grafiche



Pav.Coord. | Cemento Island

pag.86

Deck

pag.74

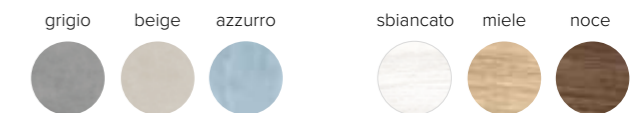

BICOTTURA

double firing

UNI EN 14411 BIII GL



FORMATO

format



MARMO LUX GRIGIO 25x60 DECORO GRIGIO 25x60

IMBALLI packing	mm	PZ box	MQ box	KG box	BOX pallet	MQ pallet	KG pallet	CODICE PREZZO price code
25x60	8	10	1,50	19,20	48	72,00	922	M31 lmq
25x60 listello decoro	8	10	1,50	19,20	48	72,00	922	M32 lmq

MARMO LUX

GRIGIO



LISTELLO GRIGIO 7 grafiche

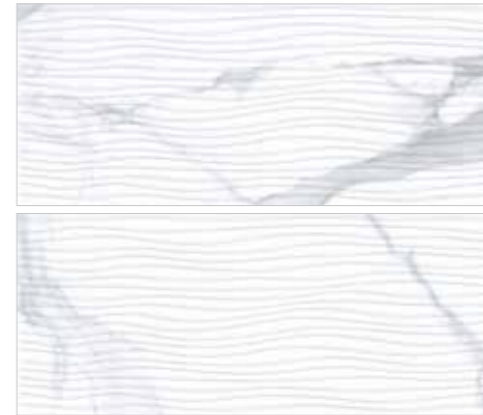

DECORO GRIGIO 7 grafiche



BEIGE



LISTELLO BEIGE 7 grafiche



DECORO BEIGE 7 grafiche



Calacatta
pag.60

Deck
pag.74

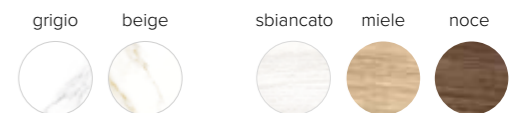

BICOTTURA

double firing

UNI EN 14411 BIII GL



FORMATO

format



COSTANZA TORTORA 20x60 NEUTRO 20x60 DECO 20x60

IMBALLI packing	mm	PZ box	MQ box	KG box	BOX pallet	MQ pallet	KG pallet	CODICE PREZZO price code
20x60	7,8	12	1,44	18,86	56	80,64	1056	M31 lmq
20x60 muretto decoro	7,8	12	1,44	18,86	56	80,64	1056	M32 lmq

NEUTRO

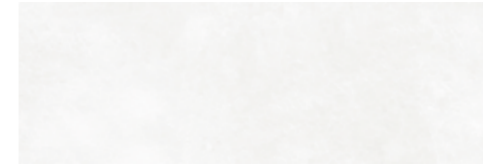

NEUTRO



GRIGIO



TORTORA



MURETTO



DECO



Costanza
pag.38

Pav.Coord. | Cemento Island
pag.86



RIVESTIMENTI

wall tiles | faïence

BICOTTURA

double firing

UNI EN 14411 BIII GL



Nat

Lux

7,8 mm



FORMATO

format



20x60



CRISTAL NEUTRA 20x60 CRISTAL SALVIA 20x60 CEMENTINA TAUPE MIX 20x60 PAV.COORD CEMENTO ISLAND VERDE 45,5x45,5

IMBALLI packing	mm	PZ box	MQ box	KG box	BOX pallet	MQ pallet	KG pallet	CODICE PREZZO price code
20x60	7,8	12	1,44	18,86	56	80,64	1056	M31 lmq
20x60 muretto cementina	7,8	12	1,44	18,86	56	80,64	1056	M32 lmq

CRISTAL

NEUTRA

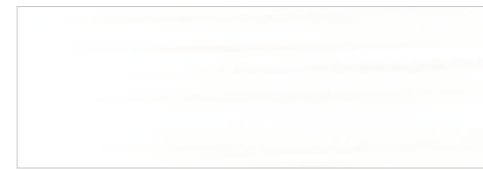

GRIGIO



AZZURRO



MURETTO GRIGIO AZZURRO

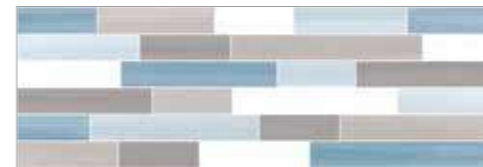

CEMENTINA GRIGIO MIX



TAUPE



SALVIA



MURETTO TAUPE SALVIA



CEMENTINA TAUPE MIX



Pav.Coord. | Cemento Island

pag.86



BICOTTURA

double firing

UNI EN 14411 BIII GL



Nat

matt

7 mm
muretto

6,4 mm



FORMATO

format



26,1x52,2



MANILA GRIGIO CHIARO 26,1x52,2 MANILA GRIGIO 26,1x52,2 MANILA MURETTO GRIGIO 26,1x52,2 MANILA DECORO METAL GRIS 26,1x52,2

IMBALLI packing	mm	PZ box	MQ box	KG box	BOX pallet	MQ pallet	KG pallet	CODICE PREZZO price code
26,1x52,2	6,4	16	2,18	24,95	39	85,02	980	B25 1mq
26,1x52,2 decoro	6,4	16	2,18	24,95	39	85,02	980	B27 1mq
26,1x52,2 muretto	7	14	1,91	24,95	39	74,49	980	B27 1mq

GRIGIO CHIARO



BEIGE



GRIGIO



CAMEL



MURETTO GRIGIO



MURETTO BEIGE



DECORO METAL GRIS



DECORO METAL BEIGE



Pav.Coord. | Cemento Island
pag.86

Deck
pag.74



CEMENTO

CLASSIC

BICOTTURA

double firing

UNI EN 14411 BIII GL



FORMATO

format



Pav.Coord. | Cemento Island

pag.86

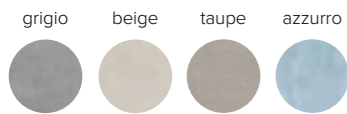

NEUTRO



NEUTRO



GRIGIO



TORTORA

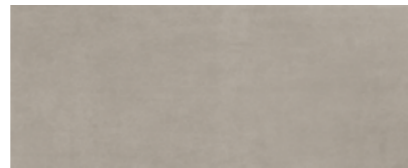

MOSAICO MURETTO GRIGIO



MOSAICO MURETTO TORTORA



DECORO UNICO



CEMENTO DECORO UNICO 20x50

IMBALLI packing	mm	PZ box	MQ box	KG box	BOX pallet	MQ pallet	KG pallet	CODICE PREZZO price code
20x50	7	14	1,40	19,15	48	67,20	930	M27 Imq
20x50 muretto decoro	7	14	1,40	19,15	48	67,20	930	M29 Imq

BICOTTURA

double firing

UNI EN 14411 BIII GL



FORMATO

format



Pav. Coord. | Riflessi Travertino

pag.86

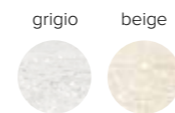

GRIGIO CHIARO



BEIGE CHIARO



GRIGIO SCURO



BEIGE SCURO



MURETTO GRIGIO



MURETTO BEIGE



LISTELLO UP GRIGIO



LISTELLO UP BEIGE



CLASSIC GRIGIO CHIARO 20x45 CLASSIC GRIGIO SCURO 20x45 CLASSIC MURETTO GRIGIO 20x45 CLASSIC LISTELLO UP GRIGIO 2,5x45

IMBALLI packing	mm	PZ box	MQ box	KG box	BOX pallet	MQ pallet	KG pallet	CODICE PREZZO price code
20x45	7	15	1,35	20,00	52	70,20	1040	M27 Imq
20x45 muretto	7	15	135	20,00	52	70,20	1040	M29 Imq
2,5x45 listello	7	6	-	-	-	-	-	Y14 lpz

BICOTTURA

double firing

UNI EN 14411 BIII GL



Matt 10x10 | 15x15 | 20x20 ECO
30x60 | 30x90

Lux 10x10 | 15x15 | 20x20 ECO
30x60 | 30x90

▼
8,5 mm
▲ 30x90

▼
8 mm
▲ 30x60

▼
6 mm
▲ 15x15 | 20x20 ECO

▼
5,8 mm
▲ 10x10



FORMATI

formats

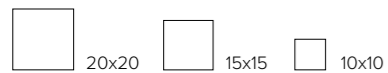
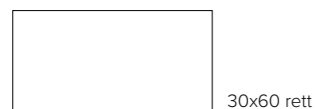
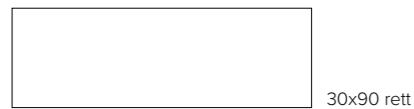

IMBALLI packing	mm	PZ box	MQ box	KG box	BOX pallet	MQ pallet	KG pallet	CODICE PREZZO price code
30x90 rett	8,5	5	1,35	19,55	63	85,05	1235	J56 Imq
30x60 rett	8	8	1,44	20,52	40	57,60	820	M29 Imq
20x20 ECO	6	40	1,60	17,00	72	115,20	1224	M19 Imq
15x15	6	44	1,00	10,60	126	126,00	1336	V32 Imq
10x10	6	50	0,50	7,00	200	100,00	1400	V48 Imq

BIANCO MATT

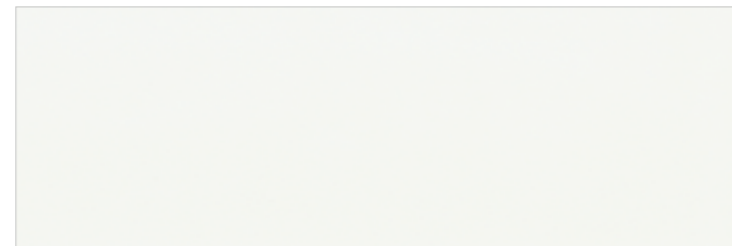

BIANCO LUX

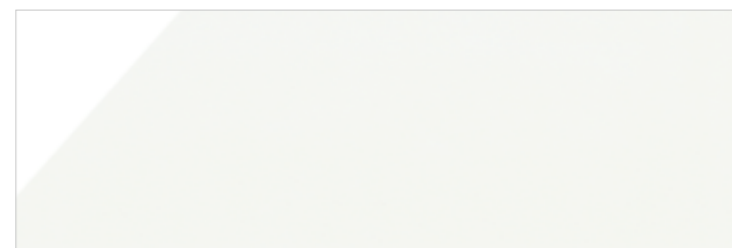

SEZIONE TECNICA

technical section | section technique

CONDIZIONI DI VENDITA



1.0 APPLICABILITÀ DELLE CONDIZIONI

- 1.1 Le presenti condizioni generali (qui di seguito le "CONDIZIONI") costituiscono parte integrante di tutti i contratti di vendita delle piastrelle ed altro materiale ceramico (qui di seguito "il/i PRODOTTI") a cui sia parte DECOR UNION 2000 (qui di seguito il "FABBRICANTE"). Salvo singoli in casi in cui esse siano state derogate con espresse pattuizioni scritte a firma del FABBRICANTE, esse costituiranno la disciplina esclusiva di tali vendite. Se una o più parti di tali CONDIZIONI o di singoli contratti che le includano risultassero invalide, le CONDIZIONI generali o particolari resteranno valide nel loro complesso; le parti invalide saranno sostituite con pattuizioni che si avvicinino il più possibile alla originaria volontà delle parti.

2.0 CONCLUSIONE DEL CONTRATTO DI VENDITA - CONSEGNA DEI PRODOTTI

- 2.1 Il Contratto si intende concluso al momento in cui il proponente o l'ordinante vengano a conoscenza del consenso scritto della controparte.
- 2.2 L'ordine non confermato per iscritto in nessun caso potrà intendersi accettato salvo esecuzione del medesimo da parte del FABBRICANTE mediante spedizione o consegna dei PRODOTTI ordinati non comporta l'accettazione dell'intero ordine, ma sola di quella parte di PRODOTTI effettivamente consegnati.
- 2.3 Salvo diverso accordo scritto la consegna dei PRODOTTI e la resa degli stessi in Italia ed all'estero avverrà secondo la formula di "Franco Fabbrica".
- 2.4 Salvo diverso accordo, tutte le date indicate come termine di consegna si intendono a titolo indicativo.

3.0 CARATTERISTICA DEI PRODOTTI - GARANZIA - RECLAMI

- 3.1 Le Piastrelle in ceramica ed altri PRODOTTI ceramici fabbricati dal FABBRICANTE sono conformi alle norme europee UNI-DIN-EN. Il FABBRICANTE vende esclusivamente ai rivenditori professionali, i quali sono responsabili della correttezza delle informazioni tecniche fornite agli utilizzatori finali e/o ai negozi al dettaglio. La classificazione del prodotto è indicata dal FABBRICANTE sul materiale pubblicitario e/o sui listini prezzi, l'Acquirente deve di conseguenza utilizzare i PRODOTTI sulla base della classificazione fornita dal FABBRICANTE. Per facilitarne le indicazioni di utilizzo, ed adattare le classificazioni standard alle specificità della produzione del Fabbricante, a fronte di ogni prodotto, nei listini o sui cataloghi sono posti dei segni che indicano l'uso specifico consigliato dal FABBRICANTE.
- 3.2 Le differenze di tonalità non sono un difetto del PRODOTTO bensì una caratteristica dello specifico materiale cotto ad alte temperature. Il particolare requisito di ingelività si applica solo ai PRODOTTI che il FABBRICANTE garantisce espressamente con apposita indicazione sul materiale pubblicitario e/o listini. In mancanza di tale indicazione i materiali ceramici si considerano solo ed unicamente per uso in interni o comunque in locali protetti da intemperie.
- 3.3 I materiali in ceramica con superficie lucida non possono essere utilizzati in locali a piano terreno con accesso all'esterno, né in locali in cui sia previsto un grande calpestio. Le piastrelle brillanti sono inoltre suscettibili di una certa scivolosità, specialmente se bagnate, il FABBRICANTE ne sconsiglia di conseguenza l'uso in locali pubblici. Per i locali ove sia previsto un grande calpestio l'acquirente dovrà acquistare solo i PRODOTTI classificati dal FABBRICANTE come PEI V (IV), ed in particolare quelle piastrelle che il FABBRICANTE consiglia SPECIFICAMENTE per uso in locali pubblici.
- 3.4 Le rappresentazioni dei PRODOTTI sui depliant ed altri materiali pubblicitari del FABBRICANTE sono puramente illustrative e non rappresentano necessariamente il risultato estetico finale di posa del PRODOTTO rappresentato.
- 3.5 Il FABBRICANTE garantisce la buona qualità e l'assenza di vizi nei PRODOTTI forniti. La garanzia non si applica per PRODOTTI classificati dal FABBRICANTE per qualità inferiore a 1° scelta o per partite di PRODOTTI di fine serie, vendute in blocco e segnalate come partite speciali. È comunque prevista una tolleranza del 5%.
- 3.6 Il FABBRICANTE non è responsabile per vizi e/o anomalie rilevate sui PRODOTTI stessi ma all'uso improprio degli stessi da parte degli acquirenti e/o dei suoi aventi causa. In particolare il FABBRICANTE non accetta reclami o contestazioni in relazione alle situazioni precedentemente descritte.
- 3.7 I reclami devono essere comunicati dall'acquirente al FABBRICANTE entro 8 giorni dalla consegna della merce. Per vizi occulti il termine è di 8 giorni dalla scoperta del vizio. In nessun caso il FABBRICANTE risponderà per vizi che vengano denunciati dopo 12 mesi dalla consegna dei PRODOTTI all'acquirente. Per i vizi occulti la garanzia si applica fino a due anni dopo la consegna dei prodotti al primo acquirente e del fabbricante. La denuncia di vizi dovrà essere notificata dal FABBRICANTE tassativamente entro e non oltre 8 giorni dalla scoperta.
- 3.8 In generale la garanzia si applica solo per i vizi rilevati in prodotti non ancora posati. Per eventuali vizi occulti rilevabili solo successivamente alla posa, ai fini dell'applicazione della garanzia, è necessario che il FABBRICANTE accerti che la posa sia stata eseguita a regola d'arte (norme DIN18352).
- 3.9 La garanzia del FABBRICANTE si limita alla sostituzione dei prodotti difettosi con altri dello stesso tipo esenti da vizi, trasporto incluso. È escluso il rimborso di altri oneri e/o spese accessorie e, in particolare i costi di demolizione e posatura dei PRODOTTI. In tutti i casi la garanzia del FABBRICANTE non potrà eccedere cinque volte il valore del materiale contestato, con un massimo assoluto di € 10.000.
- 3.10 Il FABBRICANTE non risponde per reclami dovuti ad una classificazione del materiale ceramico da parte di organismi di controllo e/o certificazione estere, diversa da quella italiana, sulla base di specifiche tecniche che non corrispondano a quelle utilizzate dal FABBRICANTE. Eventuali expertise tecnici attivati dagli acquirenti dovranno necessariamente basarsi sulla conformità del materiale venduto alle specifiche tecniche indicate dal FABBRICANTE in vigore in Italia.

4.0 PREZZI E CONDIZIONI DI PAGAMENTO

- 4.1 I prezzi di vendita dei PRODOTTI sono quelli indicati nel listino del FABBRICANTE in vigore al momento della conferma d'ordine. In casi di contratti di vendita a consegne ripartite il prezzo, se non convenuto fermo per iscritto, sarà quello del listino in vigore al momento delle singole consegne. Per tutti i PRODOTTI destinati all'estero i prezzi potranno essere calcolati, a scelta dal FABBRICANTE, nella valuta estera del paese di destinazione o in euro.
- 4.2 Tutte le spese bancarie e di negoziazioni sono a carico dell'Acquirente. In caso di ritardo dei pagamenti, il FABBRICANTE avrà diritto a percepire, senza alcuna necessità di messa in mora, oltre agli eventuali danni, un interesse moratorio pari al tasso ufficiale di sconto in Italia maggiorato del 5%.

5.0 AGENTI DEL FABBRICANTE

- 5.1 Gli agenti del FABBRICANTE promuovono le vendite e non sono autorizzati ad agire in nome e per conto del FABBRICANTE salvo specifica autorizzazione scritta.
- 5.2 Gli ordini trasmessi dagli agenti non vincolano il FABBRICANTE e devono essere espressamente accettati per iscritto dal FABBRICANTE stesso.

6.0 RISERVATO DOMINIO

- 6.1 È convenuto tra le parti che la vendita dei PRODOTTI è effettuata con riserva di proprietà a favore del FABBRICANTE sino a totale pagamento del prezzo pattuito, ai sensi dell'art. 1523 e seguenti del c.c. Tuttavia il rischio di perimenti della merce passa all'acquirente dal momento della consegna dei PRODOTTI. Nella vendita all'estero, nel caso in cui la merce sia venduta e consegnata a clienti terzi prima del passaggio di proprietà, nell'ambito di normali rapporti commerciali dell'Acquirente stesso, la riserva di proprietà favore del FABBRICANTE permane anche nei confronti dei terzi ove la legge lo consenta.
- 6.2 In caso di mora dell'Acquirente il FABBRICANTE potrà, senza necessità di alcuna formalità, compresa la messa di mora, ritirata tutta la merce oggetto di riservato dominio ed eventualmente, se la legge lo consente, tutti i titoli di credito verso terzi ad essa afferenti, con riserva di ogni ulteriore opportuno rimedio in via giudiziale per il pregiudizio subito.

7.0 FORZA MAGGIORE

- 7.1 Il FABBRICANTE non è responsabile nei confronti dell'Acquirente per ogni inadempimento, compreso la mancata o ritardata consegna, causata da eventi al di fuori del suo ragionevole controllo quali, a titolo meramente indicativo, mancata o ritardata consegna dei materiali di lavorazione da parte dei fornitori, guasti agli impianti, scioperi ed altre azioni sindacali, interruzione dei flussi energetici, sospensione o difficoltà dei trasporti.

8.0 DIRITTO APPLICABILE - FORO COMPETENTE

- 8.1 I contratti di vendita all'esportazione cui sia parte il FABBRICANTE sono regolati dalla legge italiana, ed in particolare dalla Conservazione sui Contratti di Vendita Internazionali dei beni mobili, ove non derogata dalla presente CONDIZIONI e dalla convenzione di Vienna dell'11 Aprile 1980.
- 8.2 Foro competente per tutte le controversie relative alle vendite di PRODOTTI da parte del FABBRICANTE e dei rapporti connessi a tali vendite è IL FORO della sede legale del FABBRICANTE anche qualora l'azione promossa riguarda titoli di credito rilasciati al fabbricante quali mezzi di pagamento.

GENERAL SALES CONDITIONS



1.0 APPLICABILITY CONDITIONS

- 1.1 These General conditions (the CONDITIONS) constitute the most important part of each contract of sale of tiles and any other ceramic materials (the PRODUCTS) in which DECOR UNION 2000 (the MANUFACTURER) is one of parties. Excepted single cases which they have been derogated by explicitly written agreements signed by the MANUFACTURER, they will constitute the exclusive discipline of such sales. If one or more parts of these conditions, or of single contracts including them, result to be invalid, the general or the particular CONDITIONS will remain valid as whole: invalid parts will be substituted through agreements that are as close as possible to the original will of the parties.

2.0 CONDITIONS OF THE CONTRACT OF SALE - DELIVERY

- 2.1 The contract is intended to be concluded at the moment in which the written contest of the counterpart has come to the knowledge of the proponent and of the person ordering the contract.
- 2.2 The order that has not been confirmed in writing cannot be considered accepted in any case, except for the performance of the contract itself by the MANUFACTURER through shipment or delivery of the PRODUCTS. The partial delivery of ordered PRODUCTS doesn't involve that the whole order has been accepted, but only that part of PRODUCTS actually delivered.
- 2.3 Except a different written agreement, the delivery of PRODUCTS in Italy or abroad will take place "ex-works".
- 2.4 Except a different written agreement, all the dates given as delivery dates are intended in an indicative sense.

3.0 CHARACTERISTICS OF THE PRODUCTS - WARRANTY - COMPLAINTS

- 3.1 Ceramic tiles and other CERAMIC products produced by the MANUFACTURER comply with European norms UNI-DIN-EN. The MANUFACTURER sells exclusively to professional resellers that are responsible for the accuracy of technical informations given to final users and/or to retailers. The classification of product is indicated by the MANUFACTURER on advertising material and/or on price lists. Therefore the purchaser must use the PRODUCT according to the classification given by the MANUFACTURER. To facilitate the directions for the use of products and to adapt standards qualifications to the specificity of the production, marks connected with each single product are put in price lists and catalogues, indicating the specific use advised by the MANUFACTURER.
- 3.2 Differences in the tone are not defects of the PRODUCT but a characteristic of the specific material fired at high temperatures. The particular requisite of frost resistance is applied only to those PRODUCT explicitly guaranteed by the MANUFACTURER with the relative indication on advertising material and/or price list. In case this indication is not given, ceramic material are considered only and exclusively for indoor use or use in places protected from bad weather.
- 3.3 Ceramic materials with polished surface can never be used in places located on the ground floor with access outside or in places with great pedestrian traffic. In addition polished tiles are susceptible for a certain slipperiness especially when they are wet. The MANUFACTURER advises therefore not to use them in public places. In places with great pedestrian traffic the purchase will have to buy only those PRODUCTS classified by the MANUFACTURER as PEI V, and in particular those tiles that the MANUFACTURER advises SPECIFICALLY for use in public places.
- 3.4 The pictures of the PRODUCTS on leaflets and on other advertising material by the PRODUCER are only illustrative and they do not represent necessarily the final aesthetic result of laying of the PRODUCT.
- 3.5 The MANUFACTURER guarantees the good quality and the absence of defects of the products supplied, the warranty is not applied to those PRODUCTS classified by the MANUFACTURER as non first quality products or to lots of PRODUCTS of the end of a series, sold in bulk and pointed out as special lots. However 5% tolerance is provided.
- 3.6 The MANUFACTURER is not responsible for defects and/or anomalies found out in the PRODUCTS that are not due to their quality, but to an improper use of them by the purchaser and/or by their assignees. In particular the MANUFACTURER doesn't accept complaints or contestations concerning the above mentioned situation.
- 3.7 Complaints must be communicated by the purchaser to the MANUFACTURER within 8 days from the delivery of goods. In case of defects, the term is 8 days from the discovery. In any case the MANUFACTURER is not responsible for the defects denounced 12 months after the delivery of the PRODUCTS to the purchaser. In case of hidden defects the warranty is applied to up 2 years after the delivery of the PRODUCTS on the first purchaser. The denunciation of defects must be notified to the MANUFACTURER within and not later than 8 days from the discovery.
- 3.8 In general the warranty is applied only for defects found out in products that have not yet been lied. In case of hidden defects, detectable only after lying it's necessary for the MANUFACTURER to verify that the lying has been carried out duly (conforming to DIN 1852).
- 3.9 The MANUFACTURER's warranty is limited to the substitution of faulty PRODUCTS with other products of the same model without defects, freight included. The reimbursement of other expenses or additional costs, and in particular demolition costs and money paid for a second laying of the PRODUCTS is excluded. In any case the MANUFACTURER's warranty cannot exceed 5 times the value of the contested material, with an absolute maximum of 10.000 €.
- 3.10 The MANUFACTURER is not responsible for complaints due to classifications of the ceramic material by foreign bodies for control and/or certification that is different from the Italian one, according to technical specifications that don't correspond to those used by the MANUFACTURER. In case of technical expertise acted by the purchaser, this must be necessarily on the conformity of the sold material with the specifications indicated by the MANUFACTURER in force in Italy.

4.0 PRICES AND CONDITIONS OF PAYMENT

- 4.1 The sale prices of PRODUCTS are those indicated in the price list of the MANUFACTURER in force at the moment of the confirmations of the order. In case of contracts of sale and delivery of goods divide in parts, and there is no written agreement on the subject, the price is the one indicated in the price list in force at the moment of the delivery of each single portion of goods. For all the PRODUCTS destined to the foreign market prices can be calculated at MANUFACTURER's choice in the foreign currency of the destination country or Euro.
- 4.2 Every bank and negotiation costs have to be debited to the Purchaser. In case of delay in the payment the MANUFACTURER has the right, without necessity of putting into Mora to cash a moratoria interest amount to the official discount rate in Italy, plus 5%, apart from economical damages occurred.

5.0 MANUFACTURER AGENT

- 5.1 The MANUFACTURER's agents promote sales but are not authorized to act in the name and on behalf of the MANUFACTURER except in case of a specific written permission.
- 5.2 The orders transmitted by the agents don't bind the MANUFACTURER. Therefore they must be accepted in writing by the MANUFACTURER.

6.0 RESERVED DOMINION

- 6.1 It's agreed between the parties that the sale of the PRODUCTS is carried out with reserve of propriety in favour of the MANUFACTURER up to the total payment of the agreed price, according to the Italian Civil Code, art. 1523 and following. However the risk of deterioration of the goods passes to the purchaser from the moment of the delivery of the PRODUCTS. In the sales of PRODUCTS abroad, in case of the goods are sold and delivered to third customers before the transfer of title, within the ordinary relations of the purchaser himself, the reserve of property in favour of the MANUFACTURER remains also toward third customers, when the law permits it.
- 6.2 In case of Mora of the Purchaser, the MANUFACTURER can take back all the goods object of reserved dominion without any formality, including the putting into Mora, and if the law permits it, all documents of credit to third people relative to these goods, with reserve of any proper legal remedy for the prejudices suffered.

7.0 SUPERIOR FORCE

- 7.1 The MANUFACTURER is not responsible towards the PURCHASER for non fulfilment, including non-delivery or delay in delivery due to events outside his reasonable control, as for example non-delivery of materials by the supplier, breakdown of plants, strikes or other sindacal actions, interruption of energy supply, interruption or difficulty of transport.

8.0 APPLICABLE LAW - COMPETENT COURTS

- 8.1 The contracts of sale to export in which the MANUFACTURER is one of the party are governed by the Italian law and in particular by the "Preservation of International Contracts of Sale" of movables, where it's not derogated by these CONDITIONS and by the Convention of Vienna (11 April 1980).
- 8.2 The competent court for any controversy concerning the sale of the PRODUCTS by the MANUFACTURER and the trade relation connected with the above mentioned sales is the court of the registered office of the MANUFACTURER even when the legal action started concerns documents of credits released to the MANUFACTURER, as means of payment.

CONDITIONS GÉNÉRALES DE VENTE



1.0 APPLICATION DES CONDITIONS

1.1 Les présentes conditions générales (ci-après les « CONDITIONS ») font partie intégrante de tous les contrats de vente de carreaux et autres matériaux en céramique (ci-après les « PRODUITS ») auxquels participe DECOR UNION 2000 (ci-après le « FABRICANT »). Sauf dérogation expresse par écrit signée par le FABRICANT, elles constituent le seul régime applicable à ces ventes. Si une ou plusieurs parties de ces CONDITIONS ou des contrats individuels qui les incluent s'avéraient invalides, les conditions générales ou particulières resteront valables dans leur ensemble ; les clauses invalides seront remplacées par des stipulations se rapprochant le plus possible de la volonté initiale des parties.

2.0 CONCLUSION DU CONTRAT DE VENTE – LIVRAISON DES PRODUITS

- 2.1 Le contrat est considéré comme conclu lorsque le proposant ou le donneur d'ordre a connaissance du consentement écrit de l'autre partie.
- 2.2 Une commande non confirmée par écrit ne pourra jamais être considérée comme acceptée, sauf exécution de celle-ci par le FABRICANT via l'expédition ou la livraison des PRODUITS commandés ; celle-ci ne vaut acceptation que pour la partie effectivement livrée.
- 2.3 Sauf accord écrit contraire, la livraison des PRODUITS en Italie et à l'étranger s'effectuera selon la formule « Départ Usine ».
- 2.4 Sauf stipulation contraire, toutes les dates de livraison indiquées sont à titre indicatif uniquement.

3.0 CARACTÉRISTIQUES DES PRODUITS – GARANTIE – RÉCLAMATIONS

3.1 Les carreaux en céramique et autres PRODUITS fabriqués par le FABRICANT sont conformes aux normes européennes UNI-DIN-EN. Le FABRICANT vend exclusivement à des revendeurs professionnels, lesquels sont responsables de l'exactitude des informations techniques fournies aux utilisateurs finaux et/ou aux magasins de détail.

La classification du produit est indiquée par le FABRICANT sur le matériel publicitaire et/ou les tarifs ; l'Acheteur devra donc utiliser les PRODUITS selon cette classification.

Pour faciliter l'usage recommandé et adapter les classifications standard aux spécificités de la production du FABRICANT, des symboles indiquant l'usage conseillé sont apposés pour chaque produit dans les catalogues ou les tarifs.

- 3.2 Les différences de teinte ne constituent pas un défaut mais une caractéristique du matériau cuit à haute température. La propriété de résistance au gel s'applique uniquement aux PRODUITS explicitement garantis par le FABRICANT à travers les documents publicitaires et/ou les tarifs. À défaut de cette indication, les PRODUITS sont considérés comme exclusivement destinés à un usage intérieur ou dans des lieux abrités.
- 3.3 Les matériaux brillants ne peuvent pas être utilisés dans des pièces au rez-de-chaussée avec accès direct de l'extérieur ni dans des lieux à fort passage. Ils peuvent être glissants, surtout mouillés ; le FABRICANT déconseille donc leur utilisation dans des lieux publics. Pour les zones à fort passage, seuls les PRODUITS classés PEI V (IV) par le FABRICANT, et en particulier ceux recommandés pour cet usage, doivent être utilisés.
- 3.4 Les représentations des PRODUITS dans les brochures ou autres supports du FABRICANT sont illustratives et ne représentent pas nécessairement le résultat esthétique final après pose.
- 3.5 Le FABRICANT garantit la bonne qualité et l'absence de défauts dans les PRODUITS fournis. La garantie ne s'applique pas aux PRODUITS de qualité inférieure à la première ou aux lots de fin de série vendus en bloc comme spéciaux. Une tolérance de 5 % est cependant admise.
- 3.6 Le FABRICANT n'est pas responsable des défauts résultant d'un usage inapproprié par l'acheteur ou ses ayants cause. En particulier, aucune réclamation ne sera acceptée pour les cas décrits ci-dessus.
- 3.7 Les réclamations doivent être notifiées par l'acheteur au FABRICANT dans les 8 jours suivant la livraison. Pour les vices cachés, le délai court à compter de leur découverte. En aucun cas, les réclamations ne seront acceptées au-delà de 12 mois suivant la livraison. Pour les vices cachés, la garantie est valable jusqu'à deux ans après la livraison au premier acheteur. La notification devra être effectuée au FABRICANT dans les 8 jours suivant la découverte.
- 3.8 En général, la garantie ne s'applique que pour les PRODUITS non encore posés. Pour les vices cachés détectables seulement après la pose, il est nécessaire que le FABRICANT confirme que la pose a été effectuée selon les règles de l'art (normes DIN18352).
- 3.9 La garantie du FABRICANT se limite au remplacement des PRODUITS défectueux par des produits exempts de défauts, transport inclus. Les frais annexes, notamment de dépose et de repose, sont exclus. Dans tous les cas, la garantie ne pourra excéder cinq fois la valeur des PRODUITS contestés, avec un plafond de 10 000 €.
- 3.10 Le FABRICANT n'est pas responsable des réclamations fondées sur une classification des matériaux céramiques par des organismes de certification étrangers selon des critères autres que ceux utilisés par le FABRICANT. Toute expertise technique devra se fonder sur la conformité aux spécifications techniques en vigueur en Italie.

4.0 PRIX ET CONDITIONS DE PAIEMENT

- 4.1 Les prix sont ceux figurant dans le tarif du FABRICANT en vigueur au moment de la confirmation de commande. En cas de livraisons échelonnées, le prix applicable est celui en vigueur à chaque livraison, sauf accord écrit contraire. Pour l'exportation, les prix peuvent être fixés en euros ou dans la devise du pays de destination, au choix du FABRICANT.
- 4.2 Tous les frais bancaires sont à la charge de l'Acheteur. En cas de retard de paiement, le FABRICANT est en droit de percevoir, sans mise en demeure, un intérêt moratoire équivalent au taux d'escompte officiel en Italie majoré de 5 %, en plus des éventuels dommages.

5.0 AGENTS DU FABRICANT

- 5.1 Les agents du FABRICANT ont un rôle de promotion commerciale mais ne sont pas autorisés à représenter le FABRICANT sauf autorisation écrite.
- 5.2 Les commandes transmises par les agents ne lient le FABRICANT qu'après acceptation écrite de sa part.

6.0 RÉSERVE DE PROPRIÉTÉ

- 6.1 Il est convenu que la vente est faite avec réserve de propriété en faveur du FABRICANT jusqu'au paiement intégral, conformément aux articles 1523 et suivants du Code civil. Toutefois, le risque est transféré à l'acheteur dès la livraison. Pour les ventes à l'étranger, la réserve de propriété s'applique également aux tiers si la législation locale le permet.
- 6.2 En cas de défaut de paiement, le FABRICANT pourra, sans formalité, reprendre les PRODUITS soumis à réserve de propriété et, si la loi le permet, tous les titres de créance correspondants. Il conserve tous les autres recours légaux pour les préjudices subis.

7.0 FORCE MAJEURE

- 7.1 Le FABRICANT ne peut être tenu responsable de tout manquement, y compris de retard ou de non-livraison, en raison de circonstances indépendantes de sa volonté, telles que retards fournisseurs, pannes, grèves, interruptions d'énergie ou difficultés logistiques.

8.0 LOI APPLICABLE – JURIDICTION COMPÉTENTE

- 8.1 Les contrats internationaux de vente auxquels participe le FABRICANT sont régis par le droit italien, et notamment par la Convention des Nations Unies sur les contrats de vente internationale de marchandises (Vienne, 11 avril 1980), sauf dérogation dans les présentes CONDITIONS.
- 8.2 Le tribunal compétent pour tout litige relatif à la vente des PRODUITS par le FABRICANT est celui du siège social du FABRICANT, même pour les litiges concernant des effets de commerce utilisés comme moyen de paiement.

PROVE MATERIALI CERAMICI

testing ceramic materials

Determinazione delle caratteristiche dimensionali 1 marmetta 300x300	UNI EN ISO 10545-2
Determinazione dell'assorbimento d'acqua, della porosità apparente e della densità apparente	UNI EN ISO 10545-3
Determinazione della forza di rottura e della resistenza alla flessione	UNI EN ISO 10545-4
Determinazione della resistenza all'abrasione profonda per piastrelle smaltate	UNI EN ISO 10545-6
Determinazione della resistenza all'abrasione superficiale per piastrelle non smaltate	UNI EN ISO 10545-7
Determinazione della dilatazione termica lineare	UNI EN ISO 10545-8
Determinazione della resistenza agli sbalzi termici	UNI EN ISO 10545-9
Determinazione della dilatazione dovuta all'umidità	UNI EN ISO 10545-10
Determinazione della resistenza al cavillo per piastrelle smaltate	UNI EN ISO 10545-11
Determinazione della resistenza al gelo	UNI EN ISO 10545-12
Determinazione della resistenza chimica	UNI EN ISO 10545-13
Determinazione della resistenza alle macchie	UNI EN ISO 10545-14
Determinazione del piombo e cadmio ceduto dalle piastrelle smaltate	UNI EN ISO 10545-15

AVVERTENZE DI POSA

warning for laying

CONTROLLARE SCELTA, CALIBRO E TONO PRIMA DELLA POSA VERIFICANDO I DATI DELLA SCATOLA. NON SI ACCETTANO RECLAMI PER MATERIALE POSATO.
Kindly check: choice, caliber and shade before effecting the laying, please check the data on the box. We do not accept claims for the already laid material.

LA POSA DI MATERIALE DIVERSO DA QUELLO ORDINATO O DIFETTOSO SIGNIFICA L'ACCETTAZIONE DELLE CARATTERISTICHE QUALITATIVE ED ESCLUDE CONTESTAZIONI.

The laying of material which is different from the ordered one or defective means the acceptance of the quality features and excludes any complaints.

LA GARANZIA È LIMITATA ALLA SOSTITUZIONE DEL MATERIALE EVENTUALMENTE RICONOSCIUTO DIFETTOSO. LA POSA RICHIEDE L'UTILIZZO SOLO DI PERSONALE ALTAMENTE SPECIALIZZATO. TUTTI I MATERIALI DEVONO ESSERE POSATI CON FUGA.

The warranty is limited to replacement of the material that may be recognised as defective. The installation requires highly specialized personnel only. All materials must be laid with grout lines.

LA RIPRODUZIONE DEI COLORI DI STAMPA È INDICATIVA. NON SI ACCETTANO RECLAMI IN MERITO AD EVENTUALI DIFFERENZE TRA STAMPA TIPOGRAFICA E PRODOTTO.

The reproduction of all printed colours is approximate. Any complaints concerning possible differences between printed pictures and real products will not in any way be accepted.



DECOR
UNION
2000
CERAMICHE



@2025

COORDINAMENTO MARKETING

Decorunion 2000

PROGETTO GRAFICO

Colour My Karma



Via Radici in Piano, 24 - 42014
Tressano di Castellarano (RE) - Italy
Tel. +39 0536 824.480
Fax +39 0536 824.799
e-mail: info@decorunion.it
web: www.decorunion.it